

NOTE DE CALCUL - REALIZARE BLOC ALIMENTAR S+P+E IN CAZARMA 659 CRAIOVA

| | | | | | | |
|-------|-----|-----|-----|--------|----------|----------|
| ETAJ1 | B8 | INF | Min | 1.1 | -91.888 | -10.9572 |
| ETAJ1 | B8 | INF | Min | 1.55 | -87.0062 | 21.4315 |
| ETAJ1 | B8 | INF | Min | 1.55 | -13.9123 | 16.6115 |
| ETAJ1 | B8 | INF | Min | 2.025 | -10.3833 | 21.3376 |
| ETAJ1 | B8 | INF | Min | 2.5 | -3.3575 | 17.2116 |
| ETAJ1 | B8 | INF | Min | 2.975 | 7.1649 | 9.8751 |
| ETAJ1 | B8 | INF | Min | 3.45 | 19.0047 | -16.19 |
| ETAJ1 | B8 | INF | Min | 3.925 | 27.5027 | -47.1171 |
| ETAJ1 | B8 | INF | Min | 4.4 | 32.0129 | -81.2502 |
| ETAJ1 | B28 | INF | Max | 0.2 | -18.2663 | 10.8289 |
| ETAJ1 | B28 | INF | Max | 0.6875 | -13.0861 | 18.6207 |
| ETAJ1 | B28 | INF | Max | 1.175 | -4.2227 | 22.9894 |
| ETAJ1 | B28 | INF | Max | 1.6625 | 8.2505 | 22.1427 |
| ETAJ1 | B28 | INF | Max | 2.15 | 23.0399 | 23.8378 |
| ETAJ1 | B28 | INF | Max | 2.6375 | 37.8293 | 19.2767 |
| ETAJ1 | B28 | INF | Max | 3.125 | 50.3026 | 17.0266 |
| ETAJ1 | B28 | INF | Max | 3.6125 | 63.5709 | 9.5611 |
| ETAJ1 | B28 | INF | Max | 4.1 | 71.6025 | -1.3274 |
| ETAJ1 | B28 | INF | Min | 0.2 | -60.9827 | -66.409 |
| ETAJ1 | B28 | INF | Min | 0.6875 | -52.951 | -39.25 |
| ETAJ1 | B28 | INF | Min | 1.175 | -43.9502 | -15.5142 |
| ETAJ1 | B28 | INF | Min | 1.6625 | -31.477 | 3.0063 |
| ETAJ1 | B28 | INF | Min | 2.15 | -16.6876 | 8.3149 |
| ETAJ1 | B28 | INF | Min | 2.6375 | -1.8982 | -0.3212 |
| ETAJ1 | B28 | INF | Min | 3.125 | 10.5751 | -21.9385 |
| ETAJ1 | B28 | INF | Min | 3.6125 | 19.4384 | -48.771 |
| ETAJ1 | B28 | INF | Min | 4.1 | 24.6186 | -79.0267 |
| ETAJ1 | B29 | INF | Max | 0.2 | -25.1892 | 14.3333 |
| ETAJ1 | B29 | INF | Max | 0.6667 | -20.3057 | 25.08 |
| ETAJ1 | B29 | INF | Max | 1.1333 | -12.0472 | 32.7603 |
| ETAJ1 | B29 | INF | Max | 1.6 | -0.4353 | 35.7996 |
| ETAJ1 | B29 | INF | Max | 2.0667 | 13.4584 | 41.3065 |
| ETAJ1 | B29 | INF | Max | 2.5333 | 28.6178 | 40.8341 |
| ETAJ1 | B29 | INF | Max | 3 | 42.5115 | 29.6343 |
| ETAJ1 | B29 | INF | Max | 3.4667 | 54.5699 | 25.8202 |
| ETAJ1 | B29 | INF | Max | 3.9333 | 67.735 | 17.3653 |
| ETAJ1 | B29 | INF | Max | 4.4 | 75.2983 | 5.8438 |
| ETAJ1 | B29 | INF | Min | 0.2 | -73.2738 | -75.5437 |
| ETAJ1 | B29 | INF | Min | 0.6667 | -65.7104 | -45.9361 |
| ETAJ1 | B29 | INF | Min | 1.1333 | -52.5454 | -19.395 |
| ETAJ1 | B29 | INF | Min | 1.6 | -40.8514 | 2.5051 |
| ETAJ1 | B29 | INF | Min | 2.0667 | -26.9577 | 14.1392 |
| ETAJ1 | B29 | INF | Min | 2.5333 | -11.7983 | 13.9771 |
| ETAJ1 | B29 | INF | Min | 3 | 2.0954 | 6.3463 |
| ETAJ1 | B29 | INF | Min | 3.4667 | 13.7073 | -16.3286 |
| ETAJ1 | B29 | INF | Min | 3.9333 | 21.9658 | -43.6444 |

**BREVIAR DE CALCUL - REPARATIICAPITALE, CONSOLIDARE, RESTAURARE, EXTINDERE ȘI REFACERE
ÎMPREJMUIRE LA SEDIUL JUDECĂTORIEI HUȘI**

| | | | | | | |
|-------|-----|-----|-----|--------|----------|----------|
| ETAJ1 | B29 | INF | Min | 4.4 | 26.7757 | -74.0266 |
| ETAJ1 | B30 | INF | Max | 0.2 | -30.7238 | -11.284 |
| ETAJ1 | B30 | INF | Max | 0.7 | -27.1623 | 7.3685 |
| ETAJ1 | B30 | INF | Max | 1.2 | -21.7264 | 22.3855 |
| ETAJ1 | B30 | INF | Max | 1.7 | -11.9552 | 39.6979 |
| ETAJ1 | B30 | INF | Max | 2.2 | 5.0199 | 54.9749 |
| ETAJ1 | B30 | INF | Max | 2.7 | 24.0582 | 55.3351 |
| ETAJ1 | B30 | INF | Max | 3.2 | 42.3819 | 40.7969 |
| ETAJ1 | B30 | INF | Max | 3.7 | 63.5609 | 32.0535 |
| ETAJ1 | B30 | INF | Max | 4.2 | 78.3093 | 17.7236 |
| ETAJ1 | B30 | INF | Max | 4.7 | 86.6273 | -0.2556 |
| ETAJ1 | B30 | INF | Min | 0.2 | -88.0679 | -71.7407 |
| ETAJ1 | B30 | INF | Min | 0.7 | -79.7499 | -37.8759 |
| ETAJ1 | B30 | INF | Min | 1.2 | -65.0015 | -7.6743 |
| ETAJ1 | B30 | INF | Min | 1.7 | -43.8225 | 13.5524 |
| ETAJ1 | B30 | INF | Min | 2.2 | -25.4047 | 18.5424 |
| ETAJ1 | B30 | INF | Min | 2.7 | -6.3665 | 18.6158 |
| ETAJ1 | B30 | INF | Min | 3.2 | 10.6086 | 9.9797 |
| ETAJ1 | B30 | INF | Min | 3.7 | 21.4327 | -13.9759 |
| ETAJ1 | B30 | INF | Min | 4.2 | 26.8686 | -43.5182 |
| ETAJ1 | B30 | INF | Min | 4.7 | 30.43 | -76.7097 |
| ETAJ1 | B31 | INF | Max | 0.2 | 12.8285 | 33.8654 |
| ETAJ1 | B31 | INF | Max | 0.6417 | 17.3649 | 27.309 |
| ETAJ1 | B31 | INF | Max | 1.0833 | 24.9243 | 18.0814 |
| ETAJ1 | B31 | INF | Max | 1.525 | 35.5069 | 6.3033 |
| ETAJ1 | B31 | INF | Max | 1.9667 | 46.0895 | 14.3832 |
| ETAJ1 | B31 | INF | Max | 2.4083 | 53.6489 | 21.9744 |
| ETAJ1 | B31 | INF | Max | 2.85 | 58.1852 | 26.8945 |
| ETAJ1 | B31 | INF | Min | 0.2 | -54.4802 | -57.3805 |
| ETAJ1 | B31 | INF | Min | 0.6417 | -49.9439 | -34.2089 |
| ETAJ1 | B31 | INF | Min | 1.0833 | -42.3845 | -13.7085 |
| ETAJ1 | B31 | INF | Min | 1.525 | -31.8019 | 2.5359 |
| ETAJ1 | B31 | INF | Min | 1.9667 | -21.2193 | -13.283 |
| ETAJ1 | B31 | INF | Min | 2.4083 | -13.6599 | -35.4199 |
| ETAJ1 | B31 | INF | Min | 2.85 | -9.1235 | -60.2278 |
| ETAJ1 | B33 | INF | Max | 0.2 | -17.2743 | 13.6027 |
| ETAJ1 | B33 | INF | Max | 0.6813 | -12.1839 | 20.835 |
| ETAJ1 | B33 | INF | Max | 1.1625 | -3.5041 | 24.7538 |
| ETAJ1 | B33 | INF | Max | 1.6438 | 8.765 | 26.5719 |
| ETAJ1 | B33 | INF | Max | 2.125 | 24.6234 | 33.9645 |
| ETAJ1 | B33 | INF | Max | 2.6063 | 41.47 | 35.0353 |
| ETAJ1 | B33 | INF | Max | 3.0875 | 56.083 | 36.5308 |
| ETAJ1 | B33 | INF | Max | 3.5688 | 67.1867 | 31.8228 |
| ETAJ1 | B33 | INF | Max | 4.05 | 78.8959 | 22.6348 |
| ETAJ1 | B33 | INF | Max | 4.05 | 7.3966 | 11.9687 |

NOTE DE CALCUL - REALIZARE BLOC ALIMENTAR S+P+E IN CAZARMA 659 CRAIOVA

| | | | | | | |
|--------|-----|-----|-----|--------|----------|----------|
| PARTER | B43 | INF | Min | 3.5688 | -20.9492 | -61.939 |
| PARTER | B43 | INF | Min | 4.05 | -15.7763 | -88.3232 |
| PARTER | B44 | INF | Max | 0.2 | 44.0054 | 83.0927 |
| PARTER | B44 | INF | Max | 0.6417 | 50.2675 | 62.3326 |
| PARTER | B44 | INF | Max | 1.0833 | 58.1191 | 38.4558 |
| PARTER | B44 | INF | Max | 1.525 | 67.5604 | 12.1377 |
| PARTER | B44 | INF | Max | 1.9667 | 77.0016 | 28.7324 |
| PARTER | B44 | INF | Max | 2.4083 | 84.8533 | 51.6012 |
| PARTER | B44 | INF | Max | 2.85 | 91.1153 | 71.3532 |
| PARTER | B44 | INF | Min | 0.2 | -88.8328 | -101.633 |
| PARTER | B44 | INF | Min | 0.6417 | -82.5708 | -63.7231 |
| PARTER | B44 | INF | Min | 1.0833 | -74.7192 | -28.9298 |
| PARTER | B44 | INF | Min | 1.525 | -65.2779 | 0.6671 |
| PARTER | B44 | INF | Min | 1.9667 | -55.8367 | -21.2226 |
| PARTER | B44 | INF | Min | 2.4083 | -47.985 | -57.024 |
| PARTER | B44 | INF | Min | 2.85 | -41.723 | -95.9423 |
| PARTER | B48 | INF | Max | 0 | 39.1587 | 10.601 |
| PARTER | B48 | INF | Max | 0.45 | 44.8208 | 11.2432 |
| PARTER | B48 | INF | Max | 0.9 | 52.0057 | 23.5593 |
| PARTER | B48 | INF | Max | 1.35 | 58.4012 | 32.7194 |
| PARTER | B48 | INF | Min | 0 | -36.5381 | -5.7297 |
| PARTER | B48 | INF | Min | 0.45 | -30.876 | -9.9753 |
| PARTER | B48 | INF | Min | 0.9 | -23.6911 | -31.7227 |
| PARTER | B48 | INF | Min | 1.35 | -17.2956 | -56.6262 |
| PARTER | B49 | INF | Max | 0.2 | 19.063 | 33.5078 |
| PARTER | B49 | INF | Max | 0.6667 | 25.7271 | 23.9714 |
| PARTER | B49 | INF | Max | 1.1333 | 33.2552 | 11.2592 |
| PARTER | B49 | INF | Max | 1.6 | 39.1587 | 11.3162 |
| PARTER | B49 | INF | Min | 0.2 | -56.6338 | -53.5081 |
| PARTER | B49 | INF | Min | 0.6667 | -49.9697 | -29.4105 |
| PARTER | B49 | INF | Min | 1.1333 | -42.4416 | -8.9805 |
| PARTER | B49 | INF | Min | 1.6 | -36.5381 | -7.6435 |
| PARTER | B50 | INF | Max | 0.2 | 23.7614 | 63.491 |
| PARTER | B50 | INF | Max | 0.6643 | 30.387 | 50.9888 |
| PARTER | B50 | INF | Max | 1.1286 | 38.2597 | 35.4251 |
| PARTER | B50 | INF | Max | 1.5929 | 46.1824 | 16.7802 |
| PARTER | B50 | INF | Max | 2.0571 | 54.1051 | 23.0464 |
| PARTER | B50 | INF | Max | 2.5214 | 62.0278 | 42.0788 |
| PARTER | B50 | INF | Max | 2.9857 | 69.9006 | 57.4346 |
| PARTER | B50 | INF | Max | 3.45 | 76.5261 | 69.3665 |
| PARTER | B50 | INF | Min | 0.2 | -75.2979 | -89.6089 |
| PARTER | B50 | INF | Min | 0.6643 | -68.6723 | -56.1193 |
| PARTER | B50 | INF | Min | 1.1286 | -60.7996 | -26.416 |
| PARTER | B50 | INF | Min | 1.5929 | -52.8769 | -0.9845 |
| PARTER | B50 | INF | Min | 2.0571 | -44.9542 | -7.821 |
| PARTER | B50 | INF | Min | 2.5214 | -37.0315 | -34.7805 |

**BREVIAR DE CALCUL - REPARATIICAPITALE, CONSOLIDARE, RESTAURARE, EXTINDERE ȘI REFACERE
ÎMPREJMUIRE LA SEDIUL JUDECĂTORIEI HUȘI**

| | | | | | | |
|--------|-----|-----|-----|--------|----------|----------|
| PARTER | B50 | INF | Min | 2.9857 | -29.1587 | -65.4165 |
| PARTER | B50 | INF | Min | 3.45 | -22.5332 | -99.4763 |
| PARTER | B51 | INF | Max | 0.2 | -2.3297 | 36.1426 |
| PARTER | B51 | INF | Max | 0.6875 | 4.6732 | 35.65 |
| PARTER | B51 | INF | Max | 1.175 | 12.9609 | 31.3584 |
| PARTER | B51 | INF | Max | 1.6625 | 21.2797 | 23.0123 |
| PARTER | B51 | INF | Max | 2.15 | 29.5985 | 13.0574 |
| PARTER | B51 | INF | Max | 2.6375 | 37.9174 | 23.0567 |
| PARTER | B51 | INF | Max | 3.125 | 46.2362 | 34.6073 |
| PARTER | B51 | INF | Max | 3.6125 | 54.5239 | 42.1035 |
| PARTER | B51 | INF | Max | 4.1 | 61.5268 | 45.8005 |
| PARTER | B51 | INF | Min | 0.2 | -68.1002 | -95.2699 |
| PARTER | B51 | INF | Min | 0.6875 | -61.0972 | -63.6994 |
| PARTER | B51 | INF | Min | 1.175 | -52.8096 | -35.9279 |
| PARTER | B51 | INF | Min | 1.6625 | -44.4908 | -12.211 |
| PARTER | B51 | INF | Min | 2.15 | -36.1719 | 3.4184 |
| PARTER | B51 | INF | Min | 2.6375 | -27.8531 | -5.8463 |
| PARTER | B51 | INF | Min | 3.125 | -19.5342 | -26.3587 |
| PARTER | B51 | INF | Min | 3.6125 | -11.2466 | -50.9257 |
| PARTER | B51 | INF | Min | 4.1 | -4.2437 | -79.2917 |
| PARTER | B52 | INF | Max | 0.2 | -24.5033 | 44.7253 |
| PARTER | B52 | INF | Max | 0.6667 | -12.62 | 53.5255 |
| PARTER | B52 | INF | Max | 1.1333 | 1.8366 | 56.0647 |
| PARTER | B52 | INF | Max | 1.6 | 16.4136 | 51.8064 |
| PARTER | B52 | INF | Max | 2.0667 | 30.9905 | 45.5679 |
| PARTER | B52 | INF | Max | 2.5333 | 45.5674 | 43.5816 |
| PARTER | B52 | INF | Max | 3 | 60.1443 | 39.2754 |
| PARTER | B52 | INF | Max | 3.4667 | 74.7213 | 40.9937 |
| PARTER | B52 | INF | Max | 3.9333 | 89.1779 | 35.9145 |
| PARTER | B52 | INF | Max | 4.4 | 105.2219 | 24.5743 |
| PARTER | B52 | INF | Min | 0.2 | -96.709 | -113.337 |
| PARTER | B52 | INF | Min | 0.6667 | -83.7351 | -71.35 |
| PARTER | B52 | INF | Min | 1.1333 | -69.2784 | -35.6237 |
| PARTER | B52 | INF | Min | 1.6 | -54.7015 | -6.6951 |
| PARTER | B52 | INF | Min | 2.0667 | -40.1245 | 11.7957 |
| PARTER | B52 | INF | Min | 2.5333 | -25.5476 | 11.327 |
| PARTER | B52 | INF | Min | 3 | -10.9707 | -1.7842 |
| PARTER | B52 | INF | Min | 3.4667 | 3.6063 | -33.2528 |
| PARTER | B52 | INF | Min | 3.9333 | 18.0629 | -71.5191 |
| PARTER | B52 | INF | Min | 4.4 | 27.3754 | -116.046 |
| PARTER | B53 | INF | Max | 0.2 | 138.064 | 93.5896 |
| PARTER | B53 | INF | Max | 0.5833 | 143.4079 | 39.6791 |
| PARTER | B53 | INF | Max | 0.9667 | 149.6499 | 15.6789 |
| PARTER | B53 | INF | Max | 1.35 | 154.9937 | 69.7325 |
| PARTER | B53 | INF | Min | 0.2 | -155.367 | -99.2049 |

NOTE DE CALCUL - REALIZARE BLOC ALIMENTAR S+P+E IN CAZARMA 659 CRAIOVA

| | | | | | | |
|--------|-----|-----|-----|--------|----------|----------|
| PARTER | B38 | INF | Min | 5.05 | -16.8948 | -106.47 |
| PARTER | B39 | INF | Max | 0.2 | 18.6756 | 35.9207 |
| PARTER | B39 | INF | Max | 0.65 | 23.4796 | 26.5596 |
| PARTER | B39 | INF | Max | 1.1 | 29.8624 | 14.4806 |
| PARTER | B39 | INF | Max | 1.55 | 33.1995 | 13.9035 |
| PARTER | B39 | INF | Min | 0.2 | -89.566 | -99.6699 |
| PARTER | B39 | INF | Min | 0.65 | -84.7621 | -60.3223 |
| PARTER | B39 | INF | Min | 1.1 | -78.3793 | -23.6926 |
| PARTER | B39 | INF | Min | 1.55 | -75.0421 | -3.0322 |
| PARTER | B40 | INF | Max | 0.2 | -2.9245 | 60.2412 |
| PARTER | B40 | INF | Max | 0.6667 | 3.7395 | 60.12 |
| PARTER | B40 | INF | Max | 1.1333 | 12.1782 | 56.4749 |
| PARTER | B40 | INF | Max | 1.6 | 22.3915 | 48.4777 |
| PARTER | B40 | INF | Max | 2.0667 | 34.3795 | 35.3001 |
| PARTER | B40 | INF | Max | 2.5333 | 47.6985 | 32.218 |
| PARTER | B40 | INF | Max | 3 | 59.6865 | 37.6745 |
| PARTER | B40 | INF | Max | 3.4667 | 69.8998 | 45.3898 |
| PARTER | B40 | INF | Max | 3.9333 | 78.3385 | 48.7607 |
| PARTER | B40 | INF | Max | 4.4 | 85.0025 | 48.657 |
| PARTER | B40 | INF | Min | 0.2 | -84.5207 | -121.683 |
| PARTER | B40 | INF | Min | 0.6667 | -77.8567 | -83.7261 |
| PARTER | B40 | INF | Min | 1.1333 | -69.418 | -49.293 |
| PARTER | B40 | INF | Min | 1.6 | -59.2046 | -19.212 |
| PARTER | B40 | INF | Min | 2.0667 | -47.2167 | 5.6887 |
| PARTER | B40 | INF | Min | 2.5333 | -33.8977 | 8.4468 |
| PARTER | B40 | INF | Min | 3 | -21.9097 | -9.0834 |
| PARTER | B40 | INF | Min | 3.4667 | -11.6964 | -39.3321 |
| PARTER | B40 | INF | Min | 3.9333 | -3.2577 | -73.9407 |
| PARTER | B40 | INF | Min | 4.4 | 3.4063 | -112.123 |
| PARTER | B41 | INF | Max | 0.2 | -1.807 | 49.0616 |
| PARTER | B41 | INF | Max | 0.6556 | 4.6778 | 48.4719 |
| PARTER | B41 | INF | Max | 1.1111 | 12.8537 | 44.5428 |
| PARTER | B41 | INF | Max | 1.5667 | 22.7207 | 36.504 |
| PARTER | B41 | INF | Max | 2.0222 | 34.2789 | 28.0433 |
| PARTER | B41 | INF | Max | 2.4778 | 46.6527 | 29.1614 |
| PARTER | B41 | INF | Max | 2.9333 | 57.4685 | 41.0206 |
| PARTER | B41 | INF | Max | 3.3889 | 66.593 | 48.3378 |
| PARTER | B41 | INF | Max | 3.8444 | 74.0265 | 51.8835 |
| PARTER | B41 | INF | Max | 4.3 | 79.7688 | 52.428 |
| PARTER | B41 | INF | Min | 0.2 | -80.0408 | -105.087 |
| PARTER | B41 | INF | Min | 0.6556 | -73.5561 | -70.0371 |
| PARTER | B41 | INF | Min | 1.1111 | -65.3802 | -38.3263 |
| PARTER | B41 | INF | Min | 1.5667 | -55.5132 | -10.7253 |
| PARTER | B41 | INF | Min | 2.0222 | -43.955 | 7.3757 |
| PARTER | B41 | INF | Min | 2.4778 | -31.5812 | 5.1109 |
| PARTER | B41 | INF | Min | 2.9333 | -20.7654 | -18.6698 |

**BREVIAR DE CALCUL - REPARATII CAPITALE, CONSOLIDARE, RESTAURARE, EXTINDERE ȘI REFACERE
ÎMPREJMUIRE LA SEDIUL JUDECĂTORIEI HUȘI**

| | | | | | | |
|--------|-----|-----|-----|--------|----------|----------|
| PARTER | B41 | INF | Min | 3.3889 | -11.6408 | -46.9924 |
| PARTER | B41 | INF | Min | 3.8444 | -4.2074 | -79.0866 |
| PARTER | B41 | INF | Min | 4.3 | 1.5349 | -114.182 |
| PARTER | B42 | INF | Max | 0 | -15.8029 | 36.7919 |
| PARTER | B42 | INF | Max | 0.425 | -10.4987 | 42.4331 |
| PARTER | B42 | INF | Max | 0.85 | -3.7226 | 45.5072 |
| PARTER | B42 | INF | Max | 1.275 | 4.5163 | 45.3889 |
| PARTER | B42 | INF | Max | 1.7 | 12.7551 | 41.6684 |
| PARTER | B42 | INF | Max | 2.125 | 19.5312 | 37.58 |
| PARTER | B42 | INF | Max | 2.55 | 24.8354 | 44.0012 |
| PARTER | B42 | INF | Max | 2.55 | 44.3676 | 46.3532 |
| PARTER | B42 | INF | Max | 3.05 | 49.7421 | 40.7945 |
| PARTER | B42 | INF | Max | 3.55 | 55.1165 | 46.6997 |
| PARTER | B42 | INF | Max | 4.05 | 60.491 | 49.9201 |
| PARTER | B42 | INF | Max | 4.55 | 65.8654 | 50.456 |
| PARTER | B42 | INF | Max | 5.05 | 71.2399 | 48.3075 |
| PARTER | B42 | INF | Min | 0 | -80.6973 | -120.285 |
| PARTER | B42 | INF | Min | 0.425 | -75.3931 | -87.0633 |
| PARTER | B42 | INF | Min | 0.85 | -68.617 | -56.4091 |
| PARTER | B42 | INF | Min | 1.275 | -60.3782 | -28.9473 |
| PARTER | B42 | INF | Min | 1.7 | -52.1393 | -5.0876 |
| PARTER | B42 | INF | Min | 2.125 | -45.3632 | 12.6122 |
| PARTER | B42 | INF | Min | 2.55 | -40.059 | 15.5476 |
| PARTER | B42 | INF | Min | 2.55 | -19.873 | 16.645 |
| PARTER | B42 | INF | Min | 3.05 | -14.4986 | 6.435 |
| PARTER | B42 | INF | Min | 3.55 | -9.1241 | -19.7743 |
| PARTER | B42 | INF | Min | 4.05 | -3.7497 | -48.6722 |
| PARTER | B42 | INF | Min | 4.55 | 1.6248 | -80.2601 |
| PARTER | B42 | INF | Min | 5.05 | 6.9992 | -114.54 |
| PARTER | B43 | INF | Max | 0.2 | 16.023 | 53.0254 |
| PARTER | B43 | INF | Max | 0.6813 | 21.1959 | 44.0684 |
| PARTER | B43 | INF | Max | 1.1625 | 26.3688 | 32.6236 |
| PARTER | B43 | INF | Max | 1.6438 | 31.5417 | 18.6902 |
| PARTER | B43 | INF | Max | 2.125 | 36.7146 | 13.0936 |
| PARTER | B43 | INF | Max | 2.6063 | 41.8875 | 29.3975 |
| PARTER | B43 | INF | Max | 3.0875 | 47.0604 | 43.2127 |
| PARTER | B43 | INF | Max | 3.5688 | 52.2333 | 54.5398 |
| PARTER | B43 | INF | Max | 4.05 | 57.4062 | 63.3793 |
| PARTER | B43 | INF | Min | 0.2 | -57.1595 | -77.0203 |
| PARTER | B43 | INF | Min | 0.6813 | -51.9866 | -50.756 |
| PARTER | B43 | INF | Min | 1.1625 | -46.8137 | -26.9826 |
| PARTER | B43 | INF | Min | 1.6438 | -41.6408 | -5.6996 |
| PARTER | B43 | INF | Min | 2.125 | -36.4679 | 2.2679 |
| PARTER | B43 | INF | Min | 2.6063 | -31.295 | -16.6441 |
| PARTER | B43 | INF | Min | 3.0875 | -26.1221 | -38.0462 |

NOTE DE CALCUL - REALIZARE BLOC ALIMENTAR S+P+E IN CAZARMA 659 CRAIOVA

| | | | | | | |
|--------|-----|-----|-----|--------|----------|----------|
| PARTER | B33 | INF | Max | 0.2 | -5.0488 | 36.0514 |
| PARTER | B33 | INF | Max | 0.5988 | -1.0645 | 37.3409 |
| PARTER | B33 | INF | Max | 0.9975 | 4.4454 | 36.7099 |
| PARTER | B33 | INF | Max | 1.3963 | 11.2449 | 33.6236 |
| PARTER | B33 | INF | Max | 1.795 | 18.5723 | 35.4413 |
| PARTER | B33 | INF | Max | 1.795 | 38.6361 | 36.2829 |
| PARTER | B33 | INF | Max | 2.246 | 48.5437 | 34.1428 |
| PARTER | B33 | INF | Max | 2.697 | 60.6223 | 40.3726 |
| PARTER | B33 | INF | Max | 3.148 | 73.5846 | 46.0158 |
| PARTER | B33 | INF | Max | 3.599 | 84.1067 | 46.2598 |
| PARTER | B33 | INF | Max | 4.05 | 91.3139 | 42.5059 |
| PARTER | B33 | INF | Max | 4.05 | 8.1742 | 15.5754 |
| PARTER | B33 | INF | Max | 4.25 | 10.3093 | 13.7161 |
| PARTER | B33 | INF | Min | 0.2 | -82.2679 | -99.4178 |
| PARTER | B33 | INF | Min | 0.5988 | -78.2835 | -67.3372 |
| PARTER | B33 | INF | Min | 0.9975 | -72.7737 | -37.1771 |
| PARTER | B33 | INF | Min | 1.3963 | -65.9742 | -9.4723 |
| PARTER | B33 | INF | Min | 1.795 | -58.6467 | 12.9953 |
| PARTER | B33 | INF | Min | 1.795 | -41.0268 | 12.613 |
| PARTER | B33 | INF | Min | 2.246 | -31.1192 | 11.826 |
| PARTER | B33 | INF | Min | 2.697 | -19.0407 | -12.2401 |
| PARTER | B33 | INF | Min | 3.148 | -6.0784 | -42.525 |
| PARTER | B33 | INF | Min | 3.599 | 4.4438 | -78.2089 |
| PARTER | B33 | INF | Min | 4.05 | 11.6509 | -117.891 |
| PARTER | B33 | INF | Min | 4.05 | -24.6524 | -44.022 |
| PARTER | B33 | INF | Min | 4.25 | -22.5173 | -39.3159 |
| PARTER | B34 | INF | Max | 0.2 | 0.9082 | 57.6704 |
| PARTER | B34 | INF | Max | 0.6667 | 5.9535 | 56.2073 |
| PARTER | B34 | INF | Max | 1.1333 | 14.0249 | 51.6241 |
| PARTER | B34 | INF | Max | 1.6 | 23.8958 | 42.8402 |
| PARTER | B34 | INF | Max | 2.0667 | 34.3918 | 29.2756 |
| PARTER | B34 | INF | Max | 2.5333 | 44.8877 | 27.6167 |
| PARTER | B34 | INF | Max | 3 | 55.3837 | 33.628 |
| PARTER | B34 | INF | Max | 3.4667 | 65.2546 | 40.4425 |
| PARTER | B34 | INF | Max | 3.9333 | 73.326 | 43.0563 |
| PARTER | B34 | INF | Max | 4.4 | 78.3713 | 42.5499 |
| PARTER | B34 | INF | Min | 0.2 | -74.151 | -106.212 |
| PARTER | B34 | INF | Min | 0.6667 | -69.1058 | -72.6475 |
| PARTER | B34 | INF | Min | 1.1333 | -61.0344 | -42.203 |
| PARTER | B34 | INF | Min | 1.6 | -51.1635 | -15.9593 |
| PARTER | B34 | INF | Min | 2.0667 | -40.6675 | 5.4679 |
| PARTER | B34 | INF | Min | 2.5333 | -30.1715 | 9.0291 |
| PARTER | B34 | INF | Min | 3 | -19.6756 | -12.6554 |
| PARTER | B34 | INF | Min | 3.4667 | -9.8047 | -40.8686 |
| PARTER | B34 | INF | Min | 3.9333 | -1.7333 | -73.2825 |
| PARTER | B34 | INF | Min | 4.4 | 3.312 | -108.817 |

**BREVIAR DE CALCUL - REPARATIICAPITALE, CONSOLIDARE, RESTAURARE, EXTINDERE ȘI REFACERE
ÎMPREJMUIRE LA SEDIUL JUDECĂTORIEI HUȘI**

| | | | | | | |
|--------|-----|-----|-----|--------|----------|----------|
| PARTER | B36 | INF | Max | 0.2 | -24.1229 | 3.0713 |
| PARTER | B36 | INF | Max | 0.6556 | -20.954 | 15.3817 |
| PARTER | B36 | INF | Max | 1.1111 | -16.4407 | 24.7484 |
| PARTER | B36 | INF | Max | 1.5667 | -6.9451 | 30.1498 |
| PARTER | B36 | INF | Max | 2.0222 | 3.3009 | 30.9799 |
| PARTER | B36 | INF | Max | 2.4778 | 13.547 | 27.1423 |
| PARTER | B36 | INF | Max | 2.9333 | 23.6909 | 19.9673 |
| PARTER | B36 | INF | Max | 3.3889 | 32.8845 | 8.2363 |
| PARTER | B36 | INF | Max | 3.8444 | 43.9521 | 0.4567 |
| PARTER | B36 | INF | Max | 4.3 | 49.2225 | -6.547 |
| PARTER | B36 | INF | Min | 0.2 | -70.4404 | -81.5714 |
| PARTER | B36 | INF | Min | 0.6556 | -62.5668 | -57.3827 |
| PARTER | B36 | INF | Min | 1.1111 | -49.5706 | -36.1378 |
| PARTER | B36 | INF | Min | 1.5667 | -33.5201 | -18.8581 |
| PARTER | B36 | INF | Min | 2.0222 | -22.7732 | -6.1499 |
| PARTER | B36 | INF | Min | 2.4778 | -12.5271 | 1.8908 |
| PARTER | B36 | INF | Min | 2.9333 | -2.3832 | 5.1807 |
| PARTER | B36 | INF | Min | 3.3889 | 6.4295 | 2.9378 |
| PARTER | B36 | INF | Min | 3.8444 | 13.1353 | -11.4154 |
| PARTER | B36 | INF | Min | 4.3 | 16.5342 | -30.9145 |
| PARTER | B38 | INF | Max | 0 | -19.8106 | -10.6191 |
| PARTER | B38 | INF | Max | 0.4563 | -17.3198 | -0.4077 |
| PARTER | B38 | INF | Max | 0.9125 | -13.3037 | 12.2296 |
| PARTER | B38 | INF | Max | 1.3688 | -4.84 | 27.5139 |
| PARTER | B38 | INF | Max | 1.825 | 5.3222 | 35.4338 |
| PARTER | B38 | INF | Max | 2.2813 | 15.5839 | 35.4695 |
| PARTER | B38 | INF | Max | 2.7375 | 25.8726 | 35.2765 |
| PARTER | B38 | INF | Max | 3.1938 | 42.4473 | 30.6756 |
| PARTER | B38 | INF | Max | 3.65 | 56.1832 | 21.9371 |
| PARTER | B38 | INF | Max | 3.65 | 62.64 | 26.2167 |
| PARTER | B38 | INF | Max | 4.1167 | 70.4511 | 22.3732 |
| PARTER | B38 | INF | Max | 4.5833 | 78.1351 | 31.0061 |
| PARTER | B38 | INF | Max | 5.05 | 83.1804 | 38.9988 |
| PARTER | B38 | INF | Min | 0 | -57.028 | -34.0894 |
| PARTER | B38 | INF | Min | 0.4563 | -51.7451 | -10.0257 |
| PARTER | B38 | INF | Min | 0.9125 | -40.6495 | 4.3932 |
| PARTER | B38 | INF | Min | 1.3688 | -25.8544 | 9.355 |
| PARTER | B38 | INF | Min | 1.825 | -15.4737 | 11.4549 |
| PARTER | B38 | INF | Min | 2.2813 | -5.212 | 6.9048 |
| PARTER | B38 | INF | Min | 2.7375 | 5.0497 | -2.5462 |
| PARTER | B38 | INF | Min | 3.1938 | 14.0248 | -16.6352 |
| PARTER | B38 | INF | Min | 3.65 | 18.7338 | -34.8619 |
| PARTER | B38 | INF | Min | 3.65 | -37.4352 | -26.7405 |
| PARTER | B38 | INF | Min | 4.1167 | -29.6241 | -38.2949 |
| PARTER | B38 | INF | Min | 4.5833 | -21.9401 | -69.622 |

NOTE DE CALCUL - REALIZARE BLOC ALIMENTAR S+P+E IN CAZARMA 659 CRAIOVA

| | | | | | | |
|-------|-----|-----|-----|--------|----------|----------|
| ETAJ1 | B63 | INF | Max | 1.35 | 62.9548 | 22.6686 |
| ETAJ1 | B63 | INF | Min | 0.2 | -70.3456 | -50.754 |
| ETAJ1 | B63 | INF | Min | 0.5833 | -66.5817 | -24.5433 |
| ETAJ1 | B63 | INF | Min | 0.9667 | -61.1098 | -1.9256 |
| ETAJ1 | B63 | INF | Min | 1.35 | -57.3459 | -24.9678 |
| ETAJ1 | B66 | INF | Max | 0.2 | -24.5155 | -15.2211 |
| ETAJ1 | B66 | INF | Max | 0.6556 | -21.3466 | -0.8086 |
| ETAJ1 | B66 | INF | Max | 1.1111 | -16.8333 | 10.7666 |
| ETAJ1 | B66 | INF | Max | 1.5667 | -11.5186 | 18.5329 |
| ETAJ1 | B66 | INF | Max | 2.0222 | -2.3879 | 21.914 |
| ETAJ1 | B66 | INF | Max | 2.4778 | 7.439 | 22.018 |
| ETAJ1 | B66 | INF | Max | 2.9333 | 17.1689 | 18.353 |
| ETAJ1 | B66 | INF | Max | 3.3889 | 29.312 | 7.9777 |
| ETAJ1 | B66 | INF | Max | 3.8444 | 39.5056 | -1.0023 |
| ETAJ1 | B66 | INF | Max | 4.3 | 44.4803 | -9.6031 |
| ETAJ1 | B66 | INF | Max | 4.3 | -20.1795 | -10.8376 |
| ETAJ1 | B66 | INF | Max | 4.7563 | -17.6887 | -1.7942 |
| ETAJ1 | B66 | INF | Max | 5.2125 | -13.6725 | 12.9703 |
| ETAJ1 | B66 | INF | Max | 5.6688 | -8.6855 | 27.3359 |
| ETAJ1 | B66 | INF | Max | 6.125 | 0.6767 | 34.9665 |
| ETAJ1 | B66 | INF | Max | 6.5813 | 10.5186 | 35.3943 |
| ETAJ1 | B66 | INF | Max | 7.0375 | 22.7701 | 29.6501 |
| ETAJ1 | B66 | INF | Max | 7.4938 | 37.9219 | 23.7825 |
| ETAJ1 | B66 | INF | Max | 7.95 | 50.518 | 13.9421 |
| ETAJ1 | B66 | INF | Max | 7.95 | 41.7066 | 19.8612 |
| ETAJ1 | B66 | INF | Max | 8.4167 | 49.2201 | 12.9244 |
| ETAJ1 | B66 | INF | Max | 8.8833 | 56.6129 | 11.7907 |
| ETAJ1 | B66 | INF | Max | 9.35 | 61.4963 | 9.3284 |
| ETAJ1 | B66 | INF | Min | 0.2 | -65.3162 | -62.8887 |
| ETAJ1 | B66 | INF | Min | 0.6556 | -57.9981 | -41.7805 |
| ETAJ1 | B66 | INF | Min | 1.1111 | -46.0682 | -23.5098 |
| ETAJ1 | B66 | INF | Min | 1.5667 | -31.3887 | -9.0479 |
| ETAJ1 | B66 | INF | Min | 2.0222 | -17.3268 | 1.0288 |
| ETAJ1 | B66 | INF | Min | 2.4778 | -7.4999 | 6.6288 |
| ETAJ1 | B66 | INF | Min | 2.9333 | 2.2299 | 6.8109 |
| ETAJ1 | B66 | INF | Min | 3.3889 | 10.3183 | 3.2143 |
| ETAJ1 | B66 | INF | Min | 3.8444 | 14.3255 | -8.5142 |
| ETAJ1 | B66 | INF | Min | 4.3 | 16.8113 | -27.2112 |
| ETAJ1 | B66 | INF | Min | 4.3 | -53.2432 | -30.2554 |
| ETAJ1 | B66 | INF | Min | 4.7563 | -48.257 | -6.8971 |
| ETAJ1 | B66 | INF | Min | 5.2125 | -38.0379 | 5.0676 |
| ETAJ1 | B66 | INF | Min | 5.6688 | -24.4882 | 10.1977 |
| ETAJ1 | B66 | INF | Min | 6.125 | -11.6527 | 12.8913 |
| ETAJ1 | B66 | INF | Min | 6.5813 | -1.8108 | 13.0121 |
| ETAJ1 | B66 | INF | Min | 7.0375 | 8.0311 | 6.2697 |
| ETAJ1 | B66 | INF | Min | 7.4938 | 13.656 | -5.2231 |

**BREVIAR DE CALCUL - REPARATIICAPITALE, CONSOLIDARE, RESTAURARE, EXTINDERE ȘI REFACERE
ÎMPREJMUIRE LA SEDIUL JUDECĂTORIEI HUȘI**

| | | | | | | |
|--------|-----|-----|-----|--------|----------|----------|
| ETAJ1 | B66 | INF | Min | 7.95 | 18.365 | -20.6888 |
| ETAJ1 | B66 | INF | Min | 7.95 | -16.9885 | -13.7127 |
| ETAJ1 | B66 | INF | Min | 8.4167 | -9.475 | -21.8082 |
| ETAJ1 | B66 | INF | Min | 8.8833 | -2.0822 | -42.7253 |
| ETAJ1 | B66 | INF | Min | 9.35 | 2.8012 | -68.252 |
| PARTER | B8 | INF | Max | 0.2 | -43.2346 | 12.3009 |
| PARTER | B8 | INF | Max | 0.65 | -40.1136 | 32.0329 |
| PARTER | B8 | INF | Max | 1.1 | -34.7892 | 49.0471 |
| PARTER | B8 | INF | Max | 1.55 | -31.4521 | 65.0648 |
| PARTER | B8 | INF | Max | 1.55 | 37.6851 | 68.5531 |
| PARTER | B8 | INF | Max | 2.025 | 41.3045 | 54.7089 |
| PARTER | B8 | INF | Max | 2.5 | 48.601 | 45.0354 |
| PARTER | B8 | INF | Max | 2.975 | 59.5747 | 30.1457 |
| PARTER | B8 | INF | Max | 3.45 | 71.9337 | 29.376 |
| PARTER | B8 | INF | Max | 3.925 | 81.1968 | 23.5371 |
| PARTER | B8 | INF | Max | 4.4 | 89.5384 | 14.3702 |
| PARTER | B8 | INF | Min | 0.2 | -120.434 | -112.737 |
| PARTER | B8 | INF | Min | 0.65 | -112.692 | -68.8679 |
| PARTER | B8 | INF | Min | 1.1 | -102.183 | -27.7168 |
| PARTER | B8 | INF | Min | 1.55 | -97.0123 | 9.9635 |
| PARTER | B8 | INF | Min | 1.55 | -26.6849 | 3.786 |
| PARTER | B8 | INF | Min | 2.025 | -23.0656 | 15.7473 |
| PARTER | B8 | INF | Min | 2.5 | -15.7691 | 15.5328 |
| PARTER | B8 | INF | Min | 2.975 | -4.7954 | 3.1855 |
| PARTER | B8 | INF | Min | 3.45 | 7.5636 | -28.16 |
| PARTER | B8 | INF | Min | 3.925 | 16.4084 | -64.5747 |
| PARTER | B8 | INF | Min | 4.4 | 21.576 | -104.317 |
| PARTER | B28 | INF | Max | 0.2 | -6.0693 | 38.7607 |
| PARTER | B28 | INF | Max | 0.6875 | -0.716 | 40.572 |
| PARTER | B28 | INF | Max | 1.175 | 8.5105 | 38.8294 |
| PARTER | B28 | INF | Max | 1.6625 | 21.5333 | 31.6484 |
| PARTER | B28 | INF | Max | 2.15 | 36.9918 | 29.9149 |
| PARTER | B28 | INF | Max | 2.6375 | 52.4503 | 29.8522 |
| PARTER | B28 | INF | Max | 3.125 | 65.4731 | 35.2401 |
| PARTER | B28 | INF | Max | 3.6125 | 74.6996 | 35.1895 |
| PARTER | B28 | INF | Max | 4.1 | 80.0529 | 31.585 |
| PARTER | B28 | INF | Min | 0.2 | -76.3746 | -98.3377 |
| PARTER | B28 | INF | Min | 0.6875 | -71.0213 | -62.2526 |
| PARTER | B28 | INF | Min | 1.175 | -61.7948 | -29.7213 |
| PARTER | B28 | INF | Min | 1.6625 | -48.772 | -2.6285 |
| PARTER | B28 | INF | Min | 2.15 | -33.3135 | 8.9597 |
| PARTER | B28 | INF | Min | 2.6375 | -17.855 | -4.4186 |
| PARTER | B28 | INF | Min | 3.125 | -4.8322 | -33.3046 |
| PARTER | B28 | INF | Min | 3.6125 | 4.3943 | -67.629 |
| PARTER | B28 | INF | Min | 4.1 | 9.7475 | -105.507 |

NOTE DE CALCUL - REALIZARE BLOC ALIMENTAR S+P+E IN CAZARMA 659 CRAIOVA

| | | | | | | |
|-------|-----|-----|-----|--------|----------|----------|
| ETAJ1 | B33 | INF | Max | 4.25 | 9.4637 | 10.2723 |
| ETAJ1 | B33 | INF | Min | 0.2 | -69.4253 | -76.617 |
| ETAJ1 | B33 | INF | Min | 0.6813 | -64.3349 | -44.287 |
| ETAJ1 | B33 | INF | Min | 1.1625 | -55.6551 | -15.2704 |
| ETAJ1 | B33 | INF | Min | 1.6438 | -43.386 | 8.7053 |
| ETAJ1 | B33 | INF | Min | 2.125 | -27.5276 | 11.1465 |
| ETAJ1 | B33 | INF | Min | 2.6063 | -10.681 | -0.2334 |
| ETAJ1 | B33 | INF | Min | 3.0875 | 3.9319 | -23.8356 |
| ETAJ1 | B33 | INF | Min | 3.5688 | 15.0357 | -53.6413 |
| ETAJ1 | B33 | INF | Min | 4.05 | 22.5501 | -87.927 |
| ETAJ1 | B33 | INF | Min | 4.05 | -29.1162 | -47.1439 |
| ETAJ1 | B33 | INF | Min | 4.25 | -27.0491 | -41.5377 |
| ETAJ1 | B34 | INF | Max | 0.2 | -13.63 | 24.5804 |
| ETAJ1 | B34 | INF | Max | 0.6667 | -8.7465 | 29.9328 |
| ETAJ1 | B34 | INF | Max | 1.1333 | -0.9854 | 32.2782 |
| ETAJ1 | B34 | INF | Max | 1.6 | 8.4869 | 30.589 |
| ETAJ1 | B34 | INF | Max | 2.0667 | 18.5535 | 28.4792 |
| ETAJ1 | B34 | INF | Max | 2.5333 | 28.6201 | 26.0699 |
| ETAJ1 | B34 | INF | Max | 3 | 38.6867 | 22.4019 |
| ETAJ1 | B34 | INF | Max | 3.4667 | 48.159 | 20.9519 |
| ETAJ1 | B34 | INF | Max | 3.9333 | 56.9305 | 15.4672 |
| ETAJ1 | B34 | INF | Max | 4.4 | 64.4939 | 6.9755 |
| ETAJ1 | B34 | INF | Min | 0.2 | -54.1684 | -63.8354 |
| ETAJ1 | B34 | INF | Min | 0.6667 | -49.193 | -39.6079 |
| ETAJ1 | B34 | INF | Min | 1.1333 | -41.432 | -18.3875 |
| ETAJ1 | B34 | INF | Min | 1.6 | -31.9597 | -1.2017 |
| ETAJ1 | B34 | INF | Min | 2.0667 | -21.8931 | 10.2877 |
| ETAJ1 | B34 | INF | Min | 2.5333 | -11.8264 | 9.3895 |
| ETAJ1 | B34 | INF | Min | 3 | -1.7598 | -2.4326 |
| ETAJ1 | B34 | INF | Min | 3.4667 | 7.7125 | -22.7577 |
| ETAJ1 | B34 | INF | Min | 3.9333 | 15.4735 | -47.1174 |
| ETAJ1 | B34 | INF | Min | 4.4 | 20.357 | -74.4842 |
| ETAJ1 | B39 | INF | Max | 0.2 | -1.1318 | 12.8037 |
| ETAJ1 | B39 | INF | Max | 0.65 | 3.5192 | 12.3842 |
| ETAJ1 | B39 | INF | Max | 1.1 | 9.6715 | 9.343 |
| ETAJ1 | B39 | INF | Max | 1.55 | 12.9276 | 10.4889 |
| ETAJ1 | B39 | INF | Min | 0.2 | -65.3741 | -69.2253 |
| ETAJ1 | B39 | INF | Min | 0.65 | -60.7231 | -40.7357 |
| ETAJ1 | B39 | INF | Min | 1.1 | -54.5708 | -14.8679 |
| ETAJ1 | B39 | INF | Min | 1.55 | -51.3147 | 2.4904 |
| ETAJ1 | B40 | INF | Max | 0.2 | -10.7901 | 29.9562 |
| ETAJ1 | B40 | INF | Max | 0.6667 | -5.9803 | 33.9349 |
| ETAJ1 | B40 | INF | Max | 1.1333 | 0.5171 | 35.2753 |
| ETAJ1 | B40 | INF | Max | 1.6 | 8.702 | 33.1898 |
| ETAJ1 | B40 | INF | Max | 2.0667 | 18.5744 | 27.9369 |
| ETAJ1 | B40 | INF | Max | 2.5333 | 29.7125 | 27.9219 |

**BREVIAR DE CALCUL - REPARATII CAPITALE, CONSOLIDARE, RESTAURARE, EXTINDERE ȘI REFACERE
ÎMPREJMUIRE LA SEDIUL JUDECĂTORIEI HUȘI**

| | | | | | | |
|-------|-----|-----|-----|--------|----------|----------|
| ETAJ1 | B40 | INF | Max | 3 | 39.5849 | 26.3628 |
| ETAJ1 | B40 | INF | Max | 3.4667 | 47.7698 | 28.2861 |
| ETAJ1 | B40 | INF | Max | 3.9333 | 54.2671 | 26.7834 |
| ETAJ1 | B40 | INF | Max | 4.4 | 59.0769 | 22.6425 |
| ETAJ1 | B40 | INF | Min | 0.2 | -58.7293 | -77.2996 |
| ETAJ1 | B40 | INF | Min | 0.6667 | -53.9194 | -50.9493 |
| ETAJ1 | B40 | INF | Min | 1.1333 | -47.4221 | -27.2373 |
| ETAJ1 | B40 | INF | Min | 1.6 | -39.2372 | -6.9512 |
| ETAJ1 | B40 | INF | Min | 2.0667 | -29.3648 | 9.1216 |
| ETAJ1 | B40 | INF | Min | 2.5333 | -18.2267 | 9.1268 |
| ETAJ1 | B40 | INF | Min | 3 | -8.3543 | -0.6109 |
| ETAJ1 | B40 | INF | Min | 3.4667 | -0.1694 | -21.0593 |
| ETAJ1 | B40 | INF | Min | 3.9333 | 6.328 | -44.9336 |
| ETAJ1 | B40 | INF | Min | 4.4 | 11.1378 | -71.4461 |
| ETAJ1 | B41 | INF | Max | 0.2 | -10.7478 | 21.658 |
| ETAJ1 | B41 | INF | Max | 0.6556 | -6.0721 | 25.5502 |
| ETAJ1 | B41 | INF | Max | 1.1111 | 0.2117 | 26.9461 |
| ETAJ1 | B41 | INF | Max | 1.5667 | 8.1037 | 25.1131 |
| ETAJ1 | B41 | INF | Max | 2.0222 | 17.6038 | 23.2906 |
| ETAJ1 | B41 | INF | Max | 2.4778 | 27.8795 | 22.4948 |
| ETAJ1 | B41 | INF | Max | 2.9333 | 36.6735 | 25.3717 |
| ETAJ1 | B41 | INF | Max | 3.3889 | 43.8595 | 26.8695 |
| ETAJ1 | B41 | INF | Max | 3.8444 | 49.4373 | 25.46 |
| ETAJ1 | B41 | INF | Max | 4.3 | 53.407 | 21.8757 |
| ETAJ1 | B41 | INF | Min | 0.2 | -54.4361 | -66.5411 |
| ETAJ1 | B41 | INF | Min | 0.6556 | -49.7604 | -42.7464 |
| ETAJ1 | B41 | INF | Min | 1.1111 | -43.4766 | -21.448 |
| ETAJ1 | B41 | INF | Min | 1.5667 | -35.5846 | -3.3786 |
| ETAJ1 | B41 | INF | Min | 2.0222 | -26.0845 | 7.5789 |
| ETAJ1 | B41 | INF | Min | 2.4778 | -15.8088 | 7.3935 |
| ETAJ1 | B41 | INF | Min | 2.9333 | -7.0148 | -5.8439 |
| ETAJ1 | B41 | INF | Min | 3.3889 | 0.1712 | -24.2485 |
| ETAJ1 | B41 | INF | Min | 3.8444 | 5.749 | -45.5605 |
| ETAJ1 | B41 | INF | Min | 4.3 | 9.7187 | -69.0472 |
| ETAJ1 | B42 | INF | Max | 0 | -22.0886 | 7.545 |
| ETAJ1 | B42 | INF | Max | 0.4591 | -19.9724 | 18.1428 |
| ETAJ1 | B42 | INF | Max | 0.9182 | -15.3049 | 26.5263 |
| ETAJ1 | B42 | INF | Max | 1.3773 | -8.0318 | 31.9456 |
| ETAJ1 | B42 | INF | Max | 1.8364 | 0.8746 | 35.5995 |
| ETAJ1 | B42 | INF | Max | 2.2955 | 11.3015 | 44.6501 |
| ETAJ1 | B42 | INF | Max | 2.7545 | 22.0513 | 46.015 |
| ETAJ1 | B42 | INF | Max | 3.2136 | 32.7706 | 40.114 |
| ETAJ1 | B42 | INF | Max | 3.6727 | 42.3884 | 39.8221 |
| ETAJ1 | B42 | INF | Max | 4.1318 | 50.373 | 35.4897 |
| ETAJ1 | B42 | INF | Max | 4.5909 | 59.0494 | 27.8664 |

NOTE DE CALCUL - REALIZARE BLOC ALIMENTAR S+P+E IN CAZARMA 659 CRAIOVA

| | | | | | | |
|-------|-----|-----|-----|--------|----------|----------|
| ETAJ1 | B42 | INF | Max | 5.05 | 65.8923 | 17.7022 |
| ETAJ1 | B42 | INF | Min | 0 | -66.6296 | -82.1547 |
| ETAJ1 | B42 | INF | Min | 0.4591 | -60.9676 | -54.5339 |
| ETAJ1 | B42 | INF | Min | 0.9182 | -52.5949 | -29.1275 |
| ETAJ1 | B42 | INF | Min | 1.3773 | -45.1115 | -6.6852 |
| ETAJ1 | B42 | INF | Min | 1.8364 | -36.2052 | 11.4761 |
| ETAJ1 | B42 | INF | Min | 2.2955 | -25.7782 | 14.3764 |
| ETAJ1 | B42 | INF | Min | 2.7545 | -15.0285 | 14.8226 |
| ETAJ1 | B42 | INF | Min | 3.2136 | -4.3092 | 10.6529 |
| ETAJ1 | B42 | INF | Min | 3.6727 | 5.3086 | -6.662 |
| ETAJ1 | B42 | INF | Min | 4.1318 | 13.2933 | -28.0174 |
| ETAJ1 | B42 | INF | Min | 4.5909 | 19.203 | -52.6637 |
| ETAJ1 | B42 | INF | Min | 5.05 | 21.6633 | -79.8509 |
| ETAJ1 | B43 | INF | Max | 0.2 | -6.2327 | 24.0051 |
| ETAJ1 | B43 | INF | Max | 0.6813 | -1.2454 | 25.8765 |
| ETAJ1 | B43 | INF | Max | 1.1625 | 5.5366 | 24.9159 |
| ETAJ1 | B43 | INF | Max | 1.6438 | 14.1132 | 20.4948 |
| ETAJ1 | B43 | INF | Max | 2.125 | 24.4845 | 24.9208 |
| ETAJ1 | B43 | INF | Max | 2.6063 | 34.8558 | 30.8408 |
| ETAJ1 | B43 | INF | Max | 3.0875 | 43.4324 | 36.1353 |
| ETAJ1 | B43 | INF | Max | 3.5688 | 50.2144 | 37.7341 |
| ETAJ1 | B43 | INF | Max | 4.05 | 55.2017 | 36.5009 |
| ETAJ1 | B43 | INF | Min | 0.2 | -56.5279 | -62.8701 |
| ETAJ1 | B43 | INF | Min | 0.6813 | -51.5405 | -36.7942 |
| ETAJ1 | B43 | INF | Min | 1.1625 | -44.7586 | -13.5502 |
| ETAJ1 | B43 | INF | Min | 1.6438 | -36.1819 | 5.998 |
| ETAJ1 | B43 | INF | Min | 2.125 | -25.8107 | 8.0852 |
| ETAJ1 | B43 | INF | Min | 2.6063 | -15.4394 | -3.3067 |
| ETAJ1 | B43 | INF | Min | 3.0875 | -6.8628 | -22.2168 |
| ETAJ1 | B43 | INF | Min | 3.5688 | -0.0808 | -44.8225 |
| ETAJ1 | B43 | INF | Min | 4.05 | 4.9065 | -70.2602 |
| ETAJ1 | B44 | INF | Max | 0.2 | 27.441 | 54.2607 |
| ETAJ1 | B44 | INF | Max | 0.6417 | 31.9503 | 41.2007 |
| ETAJ1 | B44 | INF | Max | 1.0833 | 37.9713 | 25.8153 |
| ETAJ1 | B44 | INF | Max | 1.525 | 45.5038 | 7.4369 |
| ETAJ1 | B44 | INF | Max | 1.9667 | 53.0363 | 15.2708 |
| ETAJ1 | B44 | INF | Max | 2.4083 | 59.0572 | 26.8905 |
| ETAJ1 | B44 | INF | Max | 2.85 | 63.5666 | 36.1848 |
| ETAJ1 | B44 | INF | Min | 0.2 | -55.0405 | -61.8062 |
| ETAJ1 | B44 | INF | Min | 0.6417 | -50.5312 | -38.4368 |
| ETAJ1 | B44 | INF | Min | 1.0833 | -44.5102 | -17.3928 |
| ETAJ1 | B44 | INF | Min | 1.525 | -36.9777 | 0.6581 |
| ETAJ1 | B44 | INF | Min | 1.9667 | -29.4452 | -14.3797 |
| ETAJ1 | B44 | INF | Min | 2.4083 | -23.4243 | -39.1893 |
| ETAJ1 | B44 | INF | Min | 2.85 | -18.9149 | -66.3243 |
| ETAJ1 | B48 | INF | Max | 0 | 19.3484 | 8.1138 |

**BREVIAR DE CALCUL - REPARATIICAPITALE, CONSOLIDARE, RESTAURARE, EXTINDERE ȘI REFACERE
ÎMPREJMUIRE LA SEDIUL JUDECĂTORIEI HUȘI**

| | | | | | | |
|-------|-----|-----|-----|--------|----------|----------|
| ETAJ1 | B48 | INF | Max | 0.45 | 23.2599 | 6.7898 |
| ETAJ1 | B48 | INF | Max | 0.9 | 28.6196 | 11.521 |
| ETAJ1 | B48 | INF | Max | 1.35 | 33.2286 | 14.0288 |
| ETAJ1 | B48 | INF | Min | 0 | -18.4356 | -1.8406 |
| ETAJ1 | B48 | INF | Min | 0.45 | -14.524 | -2.5699 |
| ETAJ1 | B48 | INF | Min | 0.9 | -9.1644 | -13.5707 |
| ETAJ1 | B48 | INF | Min | 1.35 | -4.5554 | -27.0251 |
| ETAJ1 | B49 | INF | Max | 0.2 | 4.8204 | 16.6908 |
| ETAJ1 | B49 | INF | Max | 0.6667 | 9.6303 | 13.3846 |
| ETAJ1 | B49 | INF | Max | 1.1333 | 15.2618 | 7.5373 |
| ETAJ1 | B49 | INF | Max | 1.6 | 19.3484 | 7.6849 |
| ETAJ1 | B49 | INF | Min | 0.2 | -32.9635 | -29.4241 |
| ETAJ1 | B49 | INF | Min | 0.6667 | -28.1537 | -15.0977 |
| ETAJ1 | B49 | INF | Min | 1.1333 | -22.5222 | -3.3125 |
| ETAJ1 | B49 | INF | Min | 1.6 | -18.4356 | -2.1102 |
| ETAJ1 | B50 | INF | Max | 0.2 | 6.8546 | 31.1839 |
| ETAJ1 | B50 | INF | Max | 0.6643 | 11.6356 | 27.1616 |
| ETAJ1 | B50 | INF | Max | 1.1286 | 17.6026 | 20.589 |
| ETAJ1 | B50 | INF | Max | 1.5929 | 23.6171 | 11.2256 |
| ETAJ1 | B50 | INF | Max | 2.0571 | 29.6316 | 15.2516 |
| ETAJ1 | B50 | INF | Max | 2.5214 | 35.6461 | 24.9892 |
| ETAJ1 | B50 | INF | Max | 2.9857 | 41.6131 | 31.9361 |
| ETAJ1 | B50 | INF | Max | 3.45 | 46.3941 | 36.3326 |
| ETAJ1 | B50 | INF | Min | 0.2 | -46.7575 | -51.8803 |
| ETAJ1 | B50 | INF | Min | 0.6643 | -41.9765 | -31.4223 |
| ETAJ1 | B50 | INF | Min | 1.1286 | -36.0095 | -13.5146 |
| ETAJ1 | B50 | INF | Min | 1.5929 | -29.995 | 1.6023 |
| ETAJ1 | B50 | INF | Min | 2.0571 | -23.9805 | -2.2549 |
| ETAJ1 | B50 | INF | Min | 2.5214 | -17.966 | -17.4087 |
| ETAJ1 | B50 | INF | Min | 2.9857 | -11.999 | -35.3531 |
| ETAJ1 | B50 | INF | Min | 3.45 | -7.218 | -55.848 |
| ETAJ1 | B51 | INF | Max | 0.2 | -6.3672 | 19.5849 |
| ETAJ1 | B51 | INF | Max | 0.6875 | -1.3033 | 21.5294 |
| ETAJ1 | B51 | INF | Max | 1.175 | 4.9822 | 20.639 |
| ETAJ1 | B51 | INF | Max | 1.6625 | 11.2975 | 16.6708 |
| ETAJ1 | B51 | INF | Max | 2.15 | 17.6127 | 13.1431 |
| ETAJ1 | B51 | INF | Max | 2.6375 | 23.9279 | 15.4854 |
| ETAJ1 | B51 | INF | Max | 3.125 | 30.2431 | 20.1135 |
| ETAJ1 | B51 | INF | Max | 3.6125 | 36.5286 | 21.6638 |
| ETAJ1 | B51 | INF | Max | 4.1 | 41.5925 | 20.3792 |
| ETAJ1 | B51 | INF | Min | 0.2 | -42.9463 | -53.5897 |
| ETAJ1 | B51 | INF | Min | 0.6875 | -37.8824 | -33.8129 |
| ETAJ1 | B51 | INF | Min | 1.175 | -31.5968 | -16.871 |
| ETAJ1 | B51 | INF | Min | 1.6625 | -25.2816 | -3.0069 |
| ETAJ1 | B51 | INF | Min | 2.15 | -18.9664 | 4.426 |

NOTE DE CALCUL - REALIZARE BLOC ALIMENTAR S+P+E IN CAZARMA 659 CRAIOVA

| | | | | | | |
|-------|-----|-----|-----|--------|----------|----------|
| ETAJ1 | B51 | INF | Min | 2.6375 | -12.6512 | -0.5015 |
| ETAJ1 | B51 | INF | Min | 3.125 | -6.336 | -13.7057 |
| ETAJ1 | B51 | INF | Min | 3.6125 | -0.0504 | -29.9877 |
| ETAJ1 | B51 | INF | Min | 4.1 | 5.0135 | -49.1045 |
| ETAJ1 | B52 | INF | Max | 0.2 | -4.8931 | 28.9175 |
| ETAJ1 | B52 | INF | Max | 0.6667 | -0.0833 | 30.1443 |
| ETAJ1 | B52 | INF | Max | 1.1333 | 5.9166 | 28.7921 |
| ETAJ1 | B52 | INF | Max | 1.6 | 11.9619 | 24.6205 |
| ETAJ1 | B52 | INF | Max | 2.0667 | 18.0073 | 17.6807 |
| ETAJ1 | B52 | INF | Max | 2.5333 | 24.0526 | 14.3221 |
| ETAJ1 | B52 | INF | Max | 3 | 30.0979 | 17.056 |
| ETAJ1 | B52 | INF | Max | 3.4667 | 36.1433 | 19.6049 |
| ETAJ1 | B52 | INF | Max | 3.9333 | 42.1431 | 19.3344 |
| ETAJ1 | B52 | INF | Max | 4.4 | 46.9529 | 16.4849 |
| ETAJ1 | B52 | INF | Min | 0.2 | -43.4757 | -57.2365 |
| ETAJ1 | B52 | INF | Min | 0.6667 | -38.6659 | -38.0045 |
| ETAJ1 | B52 | INF | Min | 1.1333 | -32.666 | -21.3514 |
| ETAJ1 | B52 | INF | Min | 1.6 | -26.6207 | -7.5178 |
| ETAJ1 | B52 | INF | Min | 2.0667 | -20.5754 | 3.4415 |
| ETAJ1 | B52 | INF | Min | 2.5333 | -14.53 | 5.124 |
| ETAJ1 | B52 | INF | Min | 3 | -8.4847 | -4.8215 |
| ETAJ1 | B52 | INF | Min | 3.4667 | -2.4394 | -20.2777 |
| ETAJ1 | B52 | INF | Min | 3.9333 | 3.5605 | -38.5535 |
| ETAJ1 | B52 | INF | Min | 4.4 | 8.3703 | -59.4082 |
| ETAJ1 | B53 | INF | Max | 0.2 | 58.8784 | 46.4014 |
| ETAJ1 | B53 | INF | Max | 0.5833 | 62.7056 | 23.1342 |
| ETAJ1 | B53 | INF | Max | 0.9667 | 67.3867 | 1.0459 |
| ETAJ1 | B53 | INF | Max | 1.35 | 71.2139 | 25.0343 |
| ETAJ1 | B53 | INF | Min | 0.2 | -73.0951 | -51.9323 |
| ETAJ1 | B53 | INF | Min | 0.5833 | -69.268 | -24.6096 |
| ETAJ1 | B53 | INF | Min | 0.9667 | -64.5869 | -1.8002 |
| ETAJ1 | B53 | INF | Min | 1.35 | -60.7597 | -28.4017 |
| ETAJ1 | B54 | INF | Max | 0.2 | 21.0342 | 41.8263 |
| ETAJ1 | B54 | INF | Max | 0.6417 | 25.5436 | 31.596 |
| ETAJ1 | B54 | INF | Max | 1.0833 | 31.5645 | 19.0403 |
| ETAJ1 | B54 | INF | Max | 1.525 | 39.097 | 4.1655 |
| ETAJ1 | B54 | INF | Max | 1.9667 | 46.6295 | 14.9179 |
| ETAJ1 | B54 | INF | Max | 2.4083 | 52.6505 | 24.8435 |
| ETAJ1 | B54 | INF | Max | 2.85 | 57.1598 | 32.4437 |
| ETAJ1 | B54 | INF | Min | 0.2 | -51.2049 | -55.3828 |
| ETAJ1 | B54 | INF | Min | 0.6417 | -46.6955 | -33.7075 |
| ETAJ1 | B54 | INF | Min | 1.0833 | -40.6746 | -14.3576 |
| ETAJ1 | B54 | INF | Min | 1.525 | -33.1421 | 1.4162 |
| ETAJ1 | B54 | INF | Min | 1.9667 | -25.6096 | -15.4954 |
| ETAJ1 | B54 | INF | Min | 2.4083 | -19.5886 | -37.4754 |
| ETAJ1 | B54 | INF | Min | 2.85 | -15.0793 | -61.7808 |

**BREVIAR DE CALCUL - REPARATIICAPITALE, CONSOLIDARE, RESTAURARE, EXTINDERE ȘI REFACERE
ÎMPREJMUIRE LA SEDIUL JUDECĂTORIEI HUȘI**

| | | | | | | |
|-------|-----|-----|-----|--------|----------|----------|
| ETAJ1 | B55 | INF | Max | 0.2 | -20.2004 | 2.4956 |
| ETAJ1 | B55 | INF | Max | 0.7 | -17.4825 | 13.03 |
| ETAJ1 | B55 | INF | Max | 1.2 | -11.1431 | 20.471 |
| ETAJ1 | B55 | INF | Max | 1.7 | -2.0507 | 23.9157 |
| ETAJ1 | B55 | INF | Max | 2.2 | 8.9789 | 34.1447 |
| ETAJ1 | B55 | INF | Max | 2.7 | 21.2871 | 35.0943 |
| ETAJ1 | B55 | INF | Max | 3.2 | 32.3167 | 33.4834 |
| ETAJ1 | B55 | INF | Max | 3.7 | 41.4091 | 31.4219 |
| ETAJ1 | B55 | INF | Max | 4.2 | 49.8211 | 25.2986 |
| ETAJ1 | B55 | INF | Max | 4.7 | 57.4053 | 16.082 |
| ETAJ1 | B55 | INF | Min | 0.2 | -61.2036 | -63.876 |
| ETAJ1 | B55 | INF | Min | 0.7 | -53.6194 | -36.891 |
| ETAJ1 | B55 | INF | Min | 1.2 | -44.0446 | -12.9992 |
| ETAJ1 | B55 | INF | Min | 1.7 | -34.9522 | 6.8307 |
| ETAJ1 | B55 | INF | Min | 2.2 | -23.9225 | 11.1376 |
| ETAJ1 | B55 | INF | Min | 2.7 | -11.6144 | 11.4532 |
| ETAJ1 | B55 | INF | Min | 3.2 | -0.5847 | 1.1506 |
| ETAJ1 | B55 | INF | Min | 3.7 | 8.5077 | -17.3616 |
| ETAJ1 | B55 | INF | Min | 4.2 | 15.6628 | -39.9357 |
| ETAJ1 | B55 | INF | Min | 4.7 | 18.938 | -65.603 |
| ETAJ1 | B59 | INF | Max | 0.2 | -33.1088 | -14.3597 |
| ETAJ1 | B59 | INF | Max | 0.685 | -29.6814 | 5.0492 |
| ETAJ1 | B59 | INF | Max | 1.17 | -24.4904 | 21.0791 |
| ETAJ1 | B59 | INF | Max | 1.655 | -15.983 | 31.9648 |
| ETAJ1 | B59 | INF | Max | 2.14 | -1.3032 | 50.3923 |
| ETAJ1 | B59 | INF | Max | 2.625 | 14.2325 | 58.1196 |
| ETAJ1 | B59 | INF | Max | 3.11 | 29.7682 | 53.6143 |
| ETAJ1 | B59 | INF | Max | 3.595 | 45.7014 | 41.6274 |
| ETAJ1 | B59 | INF | Max | 4.08 | 65.6685 | 32.7976 |
| ETAJ1 | B59 | INF | Max | 4.565 | 79.6938 | 18.8237 |
| ETAJ1 | B59 | INF | Max | 5.05 | 87.6687 | 1.4708 |
| ETAJ1 | B59 | INF | Min | 0.2 | -94.312 | -88.1166 |
| ETAJ1 | B59 | INF | Min | 0.685 | -86.3371 | -52.8462 |
| ETAJ1 | B59 | INF | Min | 1.17 | -72.3118 | -20.9548 |
| ETAJ1 | B59 | INF | Min | 1.655 | -52.3447 | 5.7924 |
| ETAJ1 | B59 | INF | Min | 2.14 | -34.0073 | 17.0316 |
| ETAJ1 | B59 | INF | Min | 2.625 | -18.4716 | 19.6018 |
| ETAJ1 | B59 | INF | Min | 3.11 | -2.9359 | 18.0716 |
| ETAJ1 | B59 | INF | Min | 3.595 | 11.7439 | 4.3537 |
| ETAJ1 | B59 | INF | Min | 4.08 | 22.3462 | -20.3375 |
| ETAJ1 | B59 | INF | Min | 4.565 | 27.5372 | -50.1729 |
| ETAJ1 | B59 | INF | Min | 5.05 | 30.9645 | -83.3873 |
| ETAJ1 | B63 | INF | Max | 0.2 | 49.9551 | 39.9554 |
| ETAJ1 | B63 | INF | Max | 0.5833 | 53.719 | 20.2637 |
| ETAJ1 | B63 | INF | Max | 0.9667 | 59.1909 | 0.4791 |

NOTE DE CALCUL - REALIZARE BLOC ALIMENTAR S+P+E IN CAZARMA 659 CRAIOVA

| | | | | | | |
|--------|-----|-----|-----|--------|----------|----------|
| PARTER | B53 | INF | Min | 0.5833 | -150.023 | -40.6336 |
| PARTER | B53 | INF | Min | 0.9667 | -143.781 | -16.4903 |
| PARTER | B53 | INF | Min | 1.35 | -138.437 | -74.9186 |
| PARTER | B54 | INF | Max | 0.2 | 37.5143 | 64.0707 |
| PARTER | B54 | INF | Max | 0.6417 | 43.7763 | 46.1775 |
| PARTER | B54 | INF | Max | 1.0833 | 51.628 | 25.1676 |
| PARTER | B54 | INF | Max | 1.525 | 61.0692 | 8.0905 |
| PARTER | B54 | INF | Max | 1.9667 | 70.5105 | 30.3815 |
| PARTER | B54 | INF | Max | 2.4083 | 78.3621 | 48.8537 |
| PARTER | B54 | INF | Max | 2.85 | 84.6242 | 64.2091 |
| PARTER | B54 | INF | Min | 0.2 | -78.8782 | -82.3976 |
| PARTER | B54 | INF | Min | 0.6417 | -72.6162 | -48.8841 |
| PARTER | B54 | INF | Min | 1.0833 | -64.7645 | -18.4873 |
| PARTER | B54 | INF | Min | 1.525 | -55.3233 | 0.3388 |
| PARTER | B54 | INF | Min | 1.9667 | -45.882 | -28.7769 |
| PARTER | B54 | INF | Min | 2.4083 | -38.0304 | -61.7114 |
| PARTER | B54 | INF | Min | 2.85 | -31.7683 | -97.7627 |
| PARTER | B55 | INF | Max | 0.2 | -19.8519 | 22.3026 |
| PARTER | B55 | INF | Max | 0.7 | -13.196 | 30.7874 |
| PARTER | B55 | INF | Max | 1.2 | -3.9509 | 35.159 |
| PARTER | B55 | INF | Max | 1.7 | 7.3315 | 34.3988 |
| PARTER | B55 | INF | Max | 2.2 | 20.6512 | 39.4744 |
| PARTER | B55 | INF | Max | 2.7 | 35.3153 | 40.4698 |
| PARTER | B55 | INF | Max | 3.2 | 48.635 | 45.8287 |
| PARTER | B55 | INF | Max | 3.7 | 59.9173 | 47.9157 |
| PARTER | B55 | INF | Max | 4.2 | 69.1625 | 44.8708 |
| PARTER | B55 | INF | Max | 4.7 | 76.3705 | 37.7126 |
| PARTER | B55 | INF | Min | 0.2 | -79.0238 | -100.152 |
| PARTER | B55 | INF | Min | 0.7 | -71.8159 | -62.3574 |
| PARTER | B55 | INF | Min | 1.2 | -62.5707 | -28.6758 |
| PARTER | B55 | INF | Min | 1.7 | -51.2883 | -0.1262 |
| PARTER | B55 | INF | Min | 2.2 | -37.9687 | 10.2359 |
| PARTER | B55 | INF | Min | 2.7 | -23.3045 | 10.3772 |
| PARTER | B55 | INF | Min | 3.2 | -9.9849 | -7.5761 |
| PARTER | B55 | INF | Min | 3.7 | 1.2975 | -34.7991 |
| PARTER | B55 | INF | Min | 4.2 | 10.5427 | -67.1539 |
| PARTER | B55 | INF | Min | 4.7 | 17.7506 | -103.622 |
| PARTER | B59 | INF | Max | 0.2 | -15.3196 | 25.1837 |
| PARTER | B59 | INF | Max | 0.5375 | -12.1076 | 30.0543 |
| PARTER | B59 | INF | Max | 0.875 | -8.4358 | 33.7313 |
| PARTER | B59 | INF | Max | 0.875 | -6.016 | 33.7313 |
| PARTER | B59 | INF | Max | 1.2938 | -0.7459 | 35.458 |
| PARTER | B59 | INF | Max | 1.7125 | 5.8099 | 34.6875 |
| PARTER | B59 | INF | Max | 2.1313 | 12.5835 | 34.1228 |
| PARTER | B59 | INF | Max | 2.55 | 19.3572 | 42.0093 |
| PARTER | B59 | INF | Max | 2.55 | 38.7258 | 45.8118 |

**BREVIAR DE CALCUL - REPARATII CAPITALE, CONSOLIDARE, RESTAURARE, EXTINDERE ȘI REFACERE
ÎMPREJMUIRE LA SEDIUL JUDECĂTORIEI HUȘI**

| | | | | | | |
|--------|-----|-----|-----|--------|----------|----------|
| PARTER | B59 | INF | Max | 3.05 | 46.8138 | 37.5002 |
| PARTER | B59 | INF | Max | 3.55 | 54.9017 | 42.5442 |
| PARTER | B59 | INF | Max | 4.05 | 62.5594 | 44.2053 |
| PARTER | B59 | INF | Max | 4.55 | 68.3045 | 42.4918 |
| PARTER | B59 | INF | Max | 5.05 | 72.0125 | 38.415 |
| PARTER | B59 | INF | Min | 0.2 | -71.3135 | -100.336 |
| PARTER | B59 | INF | Min | 0.5375 | -68.1015 | -76.9693 |
| PARTER | B59 | INF | Min | 0.875 | -64.4297 | -54.815 |
| PARTER | B59 | INF | Min | 0.875 | -62.0099 | -54.815 |
| PARTER | B59 | INF | Min | 1.2938 | -56.7398 | -30.1629 |
| PARTER | B59 | INF | Min | 1.7125 | -50.184 | -8.008 |
| PARTER | B59 | INF | Min | 2.1313 | -43.4103 | 11.3274 |
| PARTER | B59 | INF | Min | 2.55 | -36.6366 | 17.5325 |
| PARTER | B59 | INF | Min | 2.55 | -23.4489 | 19.269 |
| PARTER | B59 | INF | Min | 3.05 | -15.361 | 8.5047 |
| PARTER | B59 | INF | Min | 3.55 | -7.273 | -16.3096 |
| PARTER | B59 | INF | Min | 4.05 | 0.3846 | -45.7359 |
| PARTER | B59 | INF | Min | 4.55 | 6.1298 | -78.5367 |
| PARTER | B59 | INF | Min | 5.05 | 9.8377 | -113.701 |
| PARTER | B60 | INF | Max | 0 | 0 | 0 |
| PARTER | B60 | INF | Max | 0.1 | 0.5061 | -0.0187 |
| PARTER | B60 | INF | Max | 0.1 | -15.3189 | 35.2661 |
| PARTER | B60 | INF | Max | 0.5889 | -11.5384 | 41.9899 |
| PARTER | B60 | INF | Max | 1.0778 | -3.8626 | 45.9133 |
| PARTER | B60 | INF | Max | 1.5667 | 7.7086 | 45.1319 |
| PARTER | B60 | INF | Max | 2.0556 | 22.4199 | 41.6563 |
| PARTER | B60 | INF | Max | 2.5444 | 38.9227 | 43.6881 |
| PARTER | B60 | INF | Max | 3.0333 | 54.4446 | 37.8285 |
| PARTER | B60 | INF | Max | 3.5222 | 67.5277 | 40.197 |
| PARTER | B60 | INF | Max | 4.0111 | 76.7971 | 37.0853 |
| PARTER | B60 | INF | Max | 4.5 | 82.9695 | 30.3942 |
| PARTER | B60 | INF | Min | 0 | 0 | 0 |
| PARTER | B60 | INF | Min | 0.1 | 0.3749 | -0.0253 |
| PARTER | B60 | INF | Min | 0.1 | -81.4412 | -120.862 |
| PARTER | B60 | INF | Min | 0.5889 | -77.6607 | -81.8119 |
| PARTER | B60 | INF | Min | 1.0778 | -69.9849 | -45.5621 |
| PARTER | B60 | INF | Min | 1.5667 | -58.4136 | -14.0171 |
| PARTER | B60 | INF | Min | 2.0556 | -43.7024 | 11.027 |
| PARTER | B60 | INF | Min | 2.5444 | -27.1995 | 13.6515 |
| PARTER | B60 | INF | Min | 3.0333 | -11.6776 | -0.0018 |
| PARTER | B60 | INF | Min | 3.5222 | 1.4054 | -29.9598 |
| PARTER | B60 | INF | Min | 4.0111 | 10.6748 | -65.3979 |
| PARTER | B60 | INF | Min | 4.5 | 16.0488 | -104.416 |
| PARTER | B61 | INF | Max | 0 | -29.016 | 10.1911 |
| PARTER | B61 | INF | Max | 0.455 | -25.111 | 22.7695 |

NOTE DE CALCUL - REALIZARE BLOC ALIMENTAR S+P+E IN CAZARMA 659 CRAIOVA

| | | | | | | |
|--------|-----|-----|-----|--------|----------|----------|
| PARTER | B61 | INF | Max | 0.91 | -17.2319 | 32.5305 |
| PARTER | B61 | INF | Max | 1.365 | -5.9787 | 37.9388 |
| PARTER | B61 | INF | Max | 1.82 | 8.6485 | 53.7797 |
| PARTER | B61 | INF | Max | 2.275 | 26.278 | 59.3889 |
| PARTER | B61 | INF | Max | 2.73 | 44.095 | 50.9461 |
| PARTER | B61 | INF | Max | 3.185 | 59.2212 | 44.7548 |
| PARTER | B61 | INF | Max | 3.64 | 78.9118 | 37.3858 |
| PARTER | B61 | INF | Max | 4.095 | 92.6873 | 25.4954 |
| PARTER | B61 | INF | Max | 4.55 | 100.5476 | 10.6189 |
| PARTER | B61 | INF | Min | 0 | -91.4834 | -91.0077 |
| PARTER | B61 | INF | Min | 0.455 | -84.273 | -56.1387 |
| PARTER | B61 | INF | Min | 0.91 | -71.1476 | -24.0871 |
| PARTER | B61 | INF | Min | 1.365 | -54.9691 | 3.6119 |
| PARTER | B61 | INF | Min | 1.82 | -40.3419 | 16.5151 |
| PARTER | B61 | INF | Min | 2.275 | -22.7124 | 18.011 |
| PARTER | B61 | INF | Min | 2.73 | -4.8954 | 13.5224 |
| PARTER | B61 | INF | Min | 3.185 | 10.1026 | -10.0808 |
| PARTER | B61 | INF | Min | 3.64 | 21.7265 | -39.7405 |
| PARTER | B61 | INF | Min | 4.095 | 29.2267 | -73.9215 |
| PARTER | B61 | INF | Min | 4.55 | 32.3908 | -111.089 |
| PARTER | B62 | INF | Max | 0.2 | 18.285 | 43.8984 |
| PARTER | B62 | INF | Max | 0.675 | 23.4526 | 34.1313 |
| PARTER | B62 | INF | Max | 1.15 | 32.2974 | 21.0362 |
| PARTER | B62 | INF | Max | 1.625 | 44.6564 | 12.0291 |
| PARTER | B62 | INF | Max | 2.1 | 55.6301 | 31.6307 |
| PARTER | B62 | INF | Max | 2.575 | 62.9266 | 47.4349 |
| PARTER | B62 | INF | Max | 3.05 | 66.5459 | 60.6466 |
| PARTER | B62 | INF | Max | 3.05 | -29.6614 | 5.6884 |
| PARTER | B62 | INF | Max | 3.2 | -29.0147 | 10.1911 |
| PARTER | B62 | INF | Min | 0.2 | -74.5718 | -79.8072 |
| PARTER | B62 | INF | Min | 0.675 | -69.4042 | -45.4673 |
| PARTER | B62 | INF | Min | 1.15 | -60.5594 | -14.4554 |
| PARTER | B62 | INF | Min | 1.625 | -48.2004 | 2.8095 |
| PARTER | B62 | INF | Min | 2.1 | -37.2267 | -21.0916 |
| PARTER | B62 | INF | Min | 2.575 | -29.9302 | -49.3944 |
| PARTER | B62 | INF | Min | 3.05 | -26.3109 | -80.2896 |
| PARTER | B62 | INF | Min | 3.05 | -92.5599 | -102.859 |
| PARTER | B62 | INF | Min | 3.2 | -91.4793 | -91.0079 |
| PARTER | B63 | INF | Max | 0.2 | 119.2911 | 78.6707 |
| PARTER | B63 | INF | Max | 0.5833 | 123.1751 | 32.4186 |
| PARTER | B63 | INF | Max | 0.9667 | 128.8553 | 12.7867 |
| PARTER | B63 | INF | Max | 1.35 | 132.7393 | 62.2237 |
| PARTER | B63 | INF | Min | 0.2 | -140.672 | -91.8162 |
| PARTER | B63 | INF | Min | 0.5833 | -136.788 | -38.704 |
| PARTER | B63 | INF | Min | 0.9667 | -131.108 | -16.0313 |
| PARTER | B63 | INF | Min | 1.35 | -127.224 | -66.2468 |

**BREVIAR DE CALCUL - REPARATII CAPITALE, CONSOLIDARE, RESTAURARE, EXTINDERE ȘI REFACERE
ÎMPREJMUIRE LA SEDIUL JUDECĂTORIEI HUȘI**

| | | | | | | |
|--------|-----|-----|-----|--------|----------|----------|
| PARTER | B64 | INF | Max | 0 | -11.6266 | 2.9721 |
| PARTER | B64 | INF | Max | 0.4488 | -9.9442 | 7.812 |
| PARTER | B64 | INF | Max | 0.8975 | -8.2619 | 12.3203 |
| PARTER | B64 | INF | Max | 1.3463 | -6.5796 | 20.3276 |
| PARTER | B64 | INF | Max | 1.795 | -4.8973 | 27.7622 |
| PARTER | B64 | INF | Max | 1.795 | 2.3622 | 26.9206 |
| PARTER | B64 | INF | Max | 2.286 | 5.1852 | 27.2039 |
| PARTER | B64 | INF | Max | 2.777 | 9.9727 | 24.5761 |
| PARTER | B64 | INF | Max | 3.268 | 19.6987 | 19.6245 |
| PARTER | B64 | INF | Max | 3.759 | 27.3497 | 14.0387 |
| PARTER | B64 | INF | Max | 4.25 | 31.5567 | 6.5845 |
| PARTER | B64 | INF | Min | 0 | -24.5162 | -13.7406 |
| PARTER | B64 | INF | Min | 0.4488 | -22.2451 | -4.7259 |
| PARTER | B64 | INF | Min | 0.8975 | -19.9739 | 3.1106 |
| PARTER | B64 | INF | Min | 1.3463 | -17.7028 | 9.9792 |
| PARTER | B64 | INF | Min | 1.795 | -15.4317 | 12.9488 |
| PARTER | B64 | INF | Min | 1.795 | -5.6079 | 12.684 |
| PARTER | B64 | INF | Min | 2.286 | -2.7849 | 12.1249 |
| PARTER | B64 | INF | Min | 2.777 | 2.0026 | 8.7568 |
| PARTER | B64 | INF | Min | 3.268 | 8.2635 | 2.5958 |
| PARTER | B64 | INF | Min | 3.759 | 12.1102 | -6.3579 |
| PARTER | B64 | INF | Min | 4.25 | 14.4028 | -17.1801 |
| PARTER | B65 | INF | Max | 0 | -12.1493 | 7.5085 |
| PARTER | B65 | INF | Max | 0.4375 | -9.7916 | 13.6838 |
| PARTER | B65 | INF | Max | 0.875 | -6.7163 | 18.0043 |
| PARTER | B65 | INF | Max | 0.875 | -5.0757 | 18.0043 |
| PARTER | B65 | INF | Max | 1.2938 | 0.1765 | 19.0766 |
| PARTER | B65 | INF | Max | 1.7125 | 5.3153 | 17.8775 |
| PARTER | B65 | INF | Max | 2.1313 | 9.6663 | 14.8244 |
| PARTER | B65 | INF | Max | 2.55 | 13.0381 | 10.5155 |
| PARTER | B65 | INF | Min | 0 | -30.0356 | -22.3981 |
| PARTER | B65 | INF | Min | 0.4375 | -25.087 | -13.2593 |
| PARTER | B65 | INF | Min | 0.875 | -17.4039 | -5.9753 |
| PARTER | B65 | INF | Min | 0.875 | -13.1617 | -5.9753 |
| PARTER | B65 | INF | Min | 1.2938 | -6.5971 | -2.0666 |
| PARTER | B65 | INF | Min | 1.7125 | -1.4583 | -0.4292 |
| PARTER | B65 | INF | Min | 2.1313 | 2.2549 | -0.6458 |
| PARTER | B65 | INF | Min | 2.55 | 4.5392 | -2.1182 |
| SUBSOL | B18 | INF | Max | 0 | -2.7925 | 0.7429 |
| SUBSOL | B18 | INF | Max | 0.3875 | 3.3127 | 0.6733 |
| SUBSOL | B18 | INF | Max | 0.775 | 9.5809 | -0.9142 |
| SUBSOL | B18 | INF | Min | 0 | -11.0919 | -4.5444 |
| SUBSOL | B18 | INF | Min | 0.3875 | -4.4132 | -1.6411 |
| SUBSOL | B18 | INF | Min | 0.775 | 1.855 | -2.378 |
| SUBSOL | B27 | INF | Max | 0 | -9.5682 | -0.3012 |

NOTE DE CALCUL - REALIZARE BLOC ALIMENTAR S+P+E IN CAZARMA 659 CRAIOVA

| | | | | | | |
|--------|-----|-----|-----|--------|----------|----------|
| SUBSOL | B27 | INF | Max | 0.5 | -1.4802 | 4.9037 |
| SUBSOL | B27 | INF | Max | 1 | 6.6078 | 10.4499 |
| SUBSOL | B27 | INF | Max | 1.5 | 14.2654 | 13.5096 |
| SUBSOL | B27 | INF | Max | 2 | 20.0106 | 13.1947 |
| SUBSOL | B27 | INF | Max | 2.5 | 25.0389 | 10.5165 |
| SUBSOL | B27 | INF | Min | 0 | -29.5386 | -7.7082 |
| SUBSOL | B27 | INF | Min | 0.5 | -18.1581 | 1.7279 |
| SUBSOL | B27 | INF | Min | 1 | -10.0701 | 1.179 |
| SUBSOL | B27 | INF | Min | 1.5 | -2.4125 | -4.1003 |
| SUBSOL | B27 | INF | Min | 2 | 3.3327 | -12.7542 |
| SUBSOL | B27 | INF | Min | 2.5 | 7.0406 | -23.7713 |
| SUBSOL | B28 | INF | Max | 0.2 | -24.109 | -9.4303 |
| SUBSOL | B28 | INF | Max | 0.6875 | -20.6594 | 5.7106 |
| SUBSOL | B28 | INF | Max | 1.175 | -15.4279 | 17.2977 |
| SUBSOL | B28 | INF | Max | 1.6625 | -5.8096 | 26.4061 |
| SUBSOL | B28 | INF | Max | 2.15 | 9.6489 | 33.4209 |
| SUBSOL | B28 | INF | Max | 2.6375 | 25.4394 | 27.3074 |
| SUBSOL | B28 | INF | Max | 3.125 | 47.5332 | 12.6503 |
| SUBSOL | B28 | INF | Max | 3.6125 | 62.9717 | 1.6134 |
| SUBSOL | B28 | INF | Max | 4.1 | 71.6198 | -12.9774 |
| SUBSOL | B28 | INF | Min | 0.2 | -73.4688 | -55.0094 |
| SUBSOL | B28 | INF | Min | 0.6875 | -64.8207 | -29.9106 |
| SUBSOL | B28 | INF | Min | 1.175 | -49.3822 | -8.3657 |
| SUBSOL | B28 | INF | Min | 1.6625 | -27.2884 | 7.7408 |
| SUBSOL | B28 | INF | Min | 2.15 | -10.7774 | 10.5596 |
| SUBSOL | B28 | INF | Min | 2.6375 | 4.6811 | 8.7207 |
| SUBSOL | B28 | INF | Min | 3.125 | 14.7249 | -1.5177 |
| SUBSOL | B28 | INF | Min | 3.6125 | 19.9563 | -22.5125 |
| SUBSOL | B28 | INF | Min | 4.1 | 23.4059 | -51.0227 |
| SUBSOL | B29 | INF | Max | 0.2 | -27.2022 | -19.9599 |
| SUBSOL | B29 | INF | Max | 0.6667 | -23.9365 | -2.7257 |
| SUBSOL | B29 | INF | Max | 1.1333 | -19.0379 | 11.3258 |
| SUBSOL | B29 | INF | Max | 1.6 | -12.5171 | 25.3855 |
| SUBSOL | B29 | INF | Max | 2.0667 | 1.1242 | 38.5017 |
| SUBSOL | B29 | INF | Max | 2.5333 | 16.9758 | 39.402 |
| SUBSOL | B29 | INF | Max | 3 | 36.3643 | 28.0862 |
| SUBSOL | B29 | INF | Max | 3.4667 | 56.9085 | 17.1654 |
| SUBSOL | B29 | INF | Max | 3.9333 | 71.2706 | 4.2274 |
| SUBSOL | B29 | INF | Max | 4.4 | 79.4103 | -11.8933 |
| SUBSOL | B29 | INF | Min | 0.2 | -83.2685 | -67.5645 |
| SUBSOL | B29 | INF | Min | 0.6667 | -75.1288 | -33.1304 |
| SUBSOL | B29 | INF | Min | 1.1333 | -60.7667 | -9.5187 |
| SUBSOL | B29 | INF | Min | 1.6 | -40.2225 | 7.8184 |
| SUBSOL | B29 | INF | Min | 2.0667 | -19.3618 | 11.9123 |
| SUBSOL | B29 | INF | Min | 2.5333 | -3.5102 | 12.2734 |
| SUBSOL | B29 | INF | Min | 3 | 10.9697 | 7.8689 |

**BREVIAR DE CALCUL - REPARATIICAPITALE, CONSOLIDARE, RESTAURARE, EXTINDERE ȘI REFACERE
ÎMPREJMUIRE LA SEDIUL JUDECĂTORIEI HUȘI**

| | | | | | | |
|--------|-----|-----|-----|--------|----------|----------|
| SUBSOL | B29 | INF | Min | 3.4667 | 17.4906 | -9.7909 |
| SUBSOL | B29 | INF | Min | 3.9333 | 22.3892 | -32.289 |
| SUBSOL | B29 | INF | Min | 4.4 | 25.6549 | -59.4623 |
| SUBSOL | B30 | INF | Max | 0.2 | -30.4362 | -23.3827 |
| SUBSOL | B30 | INF | Max | 0.7 | -26.8747 | -3.9249 |
| SUBSOL | B30 | INF | Max | 1.2 | -21.4388 | 15.1814 |
| SUBSOL | B30 | INF | Max | 1.7 | -14.1285 | 39.0484 |
| SUBSOL | B30 | INF | Max | 2.2 | -1.6202 | 55.4372 |
| SUBSOL | B30 | INF | Max | 2.7 | 18.304 | 55.3965 |
| SUBSOL | B30 | INF | Max | 3.2 | 47.5388 | 38.9262 |
| SUBSOL | B30 | INF | Max | 3.7 | 70.784 | 16.5212 |
| SUBSOL | B30 | INF | Max | 4.2 | 86.8862 | -2.6022 |
| SUBSOL | B30 | INF | Max | 4.7 | 95.8455 | -24.016 |
| SUBSOL | B30 | INF | Min | 0.2 | -95.6825 | -76.2813 |
| SUBSOL | B30 | INF | Min | 0.7 | -86.7233 | -31.6791 |
| SUBSOL | B30 | INF | Min | 1.2 | -70.6211 | -4.248 |
| SUBSOL | B30 | INF | Min | 1.7 | -47.3759 | 12.1495 |
| SUBSOL | B30 | INF | Min | 2.2 | -18.2698 | 16.9958 |
| SUBSOL | B30 | INF | Min | 2.7 | 1.6545 | 16.9254 |
| SUBSOL | B30 | INF | Min | 3.2 | 14.4099 | 11.9384 |
| SUBSOL | B30 | INF | Min | 3.7 | 21.7203 | -5.6733 |
| SUBSOL | B30 | INF | Min | 4.2 | 27.1562 | -33.1216 |
| SUBSOL | B30 | INF | Min | 4.7 | 30.7176 | -76.6479 |
| SUBSOL | B31 | INF | Max | 0.2 | -7.5548 | 4.0832 |
| SUBSOL | B31 | INF | Max | 0.6417 | -2.8698 | 6.5024 |
| SUBSOL | B31 | INF | Max | 1.0833 | 4.9944 | 6.1502 |
| SUBSOL | B31 | INF | Max | 1.525 | 16.0378 | 6.6031 |
| SUBSOL | B31 | INF | Max | 1.9667 | 27.0812 | 11.0508 |
| SUBSOL | B31 | INF | Max | 2.4083 | 34.9454 | 11.6617 |
| SUBSOL | B31 | INF | Max | 2.85 | 39.6303 | 9.5014 |
| SUBSOL | B31 | INF | Min | 0.2 | -40.2163 | -34.5514 |
| SUBSOL | B31 | INF | Min | 0.6417 | -35.5313 | -17.7068 |
| SUBSOL | B31 | INF | Min | 1.0833 | -27.6671 | -3.6335 |
| SUBSOL | B31 | INF | Min | 1.525 | -16.6237 | 1.601 |
| SUBSOL | B31 | INF | Min | 1.9667 | -5.5803 | -8.0165 |
| SUBSOL | B31 | INF | Min | 2.4083 | 2.2839 | -21.831 |
| SUBSOL | B31 | INF | Min | 2.85 | 6.9689 | -38.4168 |
| SUBSOL | B32 | INF | Max | 0.2 | -14.0313 | -3.6859 |
| SUBSOL | B32 | INF | Max | 0.6417 | -9.3463 | 1.6117 |
| SUBSOL | B32 | INF | Max | 1.0833 | -1.4821 | 4.1379 |
| SUBSOL | B32 | INF | Max | 1.525 | 9.5613 | 9.6614 |
| SUBSOL | B32 | INF | Max | 1.9667 | 20.6047 | 12.3876 |
| SUBSOL | B32 | INF | Max | 2.4083 | 28.9752 | 11.5632 |
| SUBSOL | B32 | INF | Max | 2.85 | 36.5211 | 7.9675 |
| SUBSOL | B32 | INF | Min | 0.2 | -42.1955 | -27.5466 |

NOTE DE CALCUL - REALIZARE BLOC ALIMENTAR S+P+E IN CAZARMA 659 CRAIOVA

| | | | | | | |
|--------|-----|-----|-----|--------|----------|----------|
| SUBSOL | B32 | INF | Min | 0.6417 | -34.6496 | -12.1553 |
| SUBSOL | B32 | INF | Min | 1.0833 | -24.4173 | 0.4647 |
| SUBSOL | B32 | INF | Min | 1.525 | -13.3739 | 2.3616 |
| SUBSOL | B32 | INF | Min | 1.9667 | -2.3305 | -4.4171 |
| SUBSOL | B32 | INF | Min | 2.4083 | 5.5337 | -15.3712 |
| SUBSOL | B32 | INF | Min | 2.85 | 10.2187 | -29.0966 |
| SUBSOL | B33 | INF | Max | 0.2 | -18.4065 | 3.3212 |
| SUBSOL | B33 | INF | Max | 0.6813 | -14.1526 | 11.4524 |
| SUBSOL | B33 | INF | Max | 1.1625 | -7.0175 | 16.6222 |
| SUBSOL | B33 | INF | Max | 1.6438 | 2.005 | 22.6629 |
| SUBSOL | B33 | INF | Max | 2.125 | 12.9147 | 27.2923 |
| SUBSOL | B33 | INF | Max | 2.6063 | 24.8636 | 22.4972 |
| SUBSOL | B33 | INF | Max | 3.0875 | 39.4876 | 19.0064 |
| SUBSOL | B33 | INF | Max | 3.5688 | 55.7379 | 11.5317 |
| SUBSOL | B33 | INF | Max | 4.05 | 68.2767 | -0.1313 |
| SUBSOL | B33 | INF | Max | 4.05 | 6.6866 | -2.1398 |
| SUBSOL | B33 | INF | Max | 4.25 | 8.8217 | -3.4949 |
| SUBSOL | B33 | INF | Min | 0.2 | -53.4848 | -42.7336 |
| SUBSOL | B33 | INF | Min | 0.6813 | -45.4149 | -22.1773 |
| SUBSOL | B33 | INF | Min | 1.1625 | -33.6334 | -4.5824 |
| SUBSOL | B33 | INF | Min | 1.6438 | -23.8134 | 7.5942 |
| SUBSOL | B33 | INF | Min | 2.125 | -12.9037 | 8.9503 |
| SUBSOL | B33 | INF | Min | 2.6063 | -0.9548 | 5.2998 |
| SUBSOL | B33 | INF | Min | 3.0875 | 10.5326 | -9.4894 |
| SUBSOL | B33 | INF | Min | 3.5688 | 18.4105 | -29.3892 |
| SUBSOL | B33 | INF | Min | 4.05 | 22.8659 | -53.4773 |
| SUBSOL | B33 | INF | Min | 4.05 | -15.8676 | -21.2869 |
| SUBSOL | B33 | INF | Min | 4.25 | -13.7325 | -18.5443 |
| SUBSOL | B34 | INF | Max | 0.2 | -21.9075 | -10.0112 |
| SUBSOL | B34 | INF | Max | 0.6667 | -18.6418 | 2.7197 |
| SUBSOL | B34 | INF | Max | 1.1333 | -13.9839 | 12.3304 |
| SUBSOL | B34 | INF | Max | 1.6 | -6.5197 | 20.4467 |
| SUBSOL | B34 | INF | Max | 2.0667 | 3.9762 | 28.3966 |
| SUBSOL | B34 | INF | Max | 2.5333 | 14.4722 | 28.0886 |
| SUBSOL | B34 | INF | Max | 3 | 27.2031 | 19.5228 |
| SUBSOL | B34 | INF | Max | 3.4667 | 43.8028 | 12.6566 |
| SUBSOL | B34 | INF | Max | 3.9333 | 57.2477 | 2.694 |
| SUBSOL | B34 | INF | Max | 4.4 | 65.3874 | -10.3888 |
| SUBSOL | B34 | INF | Min | 0.2 | -64.0675 | -46.959 |
| SUBSOL | B34 | INF | Min | 0.6667 | -55.9278 | -24.9751 |
| SUBSOL | B34 | INF | Min | 1.1333 | -42.4829 | -7.107 |
| SUBSOL | B34 | INF | Min | 1.6 | -25.8832 | 6.5604 |
| SUBSOL | B34 | INF | Min | 2.0667 | -13.7181 | 9.3431 |
| SUBSOL | B34 | INF | Min | 2.5333 | -3.2222 | 9.2676 |
| SUBSOL | B34 | INF | Min | 3 | 7.2738 | 4.8265 |
| SUBSOL | B34 | INF | Min | 3.4667 | 14.3075 | -9.1928 |

**BREVIAR DE CALCUL - REPARATIICAPITALE, CONSOLIDARE, RESTAURARE, EXTINDERE ȘI REFACERE
ÎMPREJMUIRE LA SEDIUL JUDECĂTORIEI HUȘI**

| | | | | | | |
|--------|-----|-----|-----|--------|----------|----------|
| SUBSOL | B34 | INF | Min | 3.9333 | 18.9654 | -27.4128 |
| SUBSOL | B34 | INF | Min | 4.4 | 22.2311 | -49.7306 |
| SUBSOL | B36 | INF | Max | 0.2 | -19.6731 | -10.1173 |
| SUBSOL | B36 | INF | Max | 0.6875 | -16.2235 | 2.8239 |
| SUBSOL | B36 | INF | Max | 1.175 | -11.292 | 12.2981 |
| SUBSOL | B36 | INF | Max | 1.6625 | -4.5065 | 17.994 |
| SUBSOL | B36 | INF | Max | 2.15 | 6.458 | 21.7958 |
| SUBSOL | B36 | INF | Max | 2.6375 | 19.9296 | 16.586 |
| SUBSOL | B36 | INF | Max | 3.125 | 37.54 | 3.1591 |
| SUBSOL | B36 | INF | Max | 3.6125 | 51.8356 | -6.506 |
| SUBSOL | B36 | INF | Max | 4.1 | 60.4838 | -15.8551 |
| SUBSOL | B36 | INF | Min | 0.2 | -57.5955 | -41.4899 |
| SUBSOL | B36 | INF | Min | 0.6875 | -48.9473 | -20.8144 |
| SUBSOL | B36 | INF | Min | 1.175 | -34.6517 | -5.9217 |
| SUBSOL | B36 | INF | Min | 1.6625 | -17.0413 | 4.3081 |
| SUBSOL | B36 | INF | Min | 2.15 | -4.6568 | 7.1476 |
| SUBSOL | B36 | INF | Min | 2.6375 | 6.3077 | 5.414 |
| SUBSOL | B36 | INF | Min | 3.125 | 12.3729 | -0.2949 |
| SUBSOL | B36 | INF | Min | 3.6125 | 17.3044 | -19.4684 |
| SUBSOL | B36 | INF | Min | 4.1 | 20.754 | -47.1221 |
| SUBSOL | B38 | INF | Max | 0.2 | -23.8549 | -19.4848 |
| SUBSOL | B38 | INF | Max | 0.6929 | -20.3575 | -8.5148 |
| SUBSOL | B38 | INF | Max | 1.1857 | -15.355 | 1.3783 |
| SUBSOL | B38 | INF | Max | 1.6786 | -9.4735 | 19.6809 |
| SUBSOL | B38 | INF | Max | 2.1714 | -3.3762 | 29.0573 |
| SUBSOL | B38 | INF | Max | 2.6643 | 9.0083 | 29.2229 |
| SUBSOL | B38 | INF | Max | 3.1571 | 27.1282 | 20.2312 |
| SUBSOL | B38 | INF | Max | 3.65 | 42.0951 | 6.2774 |
| SUBSOL | B38 | INF | Max | 3.65 | 21.7883 | 9.9169 |
| SUBSOL | B38 | INF | Max | 4.1167 | 29.5993 | 4.6586 |
| SUBSOL | B38 | INF | Max | 4.5833 | 42.1868 | 0.0201 |
| SUBSOL | B38 | INF | Max | 5.05 | 50.3265 | -7.5819 |
| SUBSOL | B38 | INF | Min | 0.2 | -69.5325 | -57.7217 |
| SUBSOL | B38 | INF | Min | 0.6929 | -60.7515 | -25.331 |
| SUBSOL | B38 | INF | Min | 1.1857 | -46.2352 | -0.0676 |
| SUBSOL | B38 | INF | Min | 1.6786 | -28.3689 | 6.4732 |
| SUBSOL | B38 | INF | Min | 2.1714 | -9.6803 | 9.6397 |
| SUBSOL | B38 | INF | Min | 2.6643 | 2.7211 | 9.8011 |
| SUBSOL | B38 | INF | Min | 3.1571 | 8.6692 | 6.9715 |
| SUBSOL | B38 | INF | Min | 3.65 | 13.7899 | -2.3099 |
| SUBSOL | B38 | INF | Min | 3.65 | -2.0234 | 0.4705 |
| SUBSOL | B38 | INF | Min | 4.1167 | 5.7877 | -7.1304 |
| SUBSOL | B38 | INF | Min | 4.5833 | 13.4717 | -22.6475 |
| SUBSOL | B38 | INF | Min | 5.05 | 18.0093 | -41.3617 |
| SUBSOL | B39 | INF | Max | 0.2 | -16.7977 | -8.5708 |

NOTE DE CALCUL - REALIZARE BLOC ALIMENTAR S+P+E IN CAZARMA 659 CRAIOVA

| | | | | | | |
|--------|-----|-----|-----|--------|----------|----------|
| SUBSOL | B39 | INF | Max | 0.65 | -11.9937 | -1.969 |
| SUBSOL | B39 | INF | Max | 1.1 | -5.6109 | 1.915 |
| SUBSOL | B39 | INF | Max | 1.55 | -2.2738 | 7.9798 |
| SUBSOL | B39 | INF | Min | 0.2 | -49.0845 | -41.1822 |
| SUBSOL | B39 | INF | Min | 0.65 | -41.3427 | -22.6102 |
| SUBSOL | B39 | INF | Min | 1.1 | -31.221 | -7.2017 |
| SUBSOL | B39 | INF | Min | 1.55 | -27.8839 | 2.7155 |
| SUBSOL | B1 | INF | Max | 0 | -9.3252 | -2.3465 |
| SUBSOL | B1 | INF | Max | 0.4875 | 0.0752 | 1.4981 |
| SUBSOL | B1 | INF | Max | 0.975 | 7.5389 | 15.4573 |
| SUBSOL | B1 | INF | Max | 1.4625 | 13.0659 | 26.3536 |
| SUBSOL | B1 | INF | Max | 1.95 | 16.6563 | 35.0274 |
| SUBSOL | B1 | INF | Min | 0 | -42.1402 | -16.7788 |
| SUBSOL | B1 | INF | Min | 0.4875 | -32.7399 | -0.274 |
| SUBSOL | B1 | INF | Min | 0.975 | -25.2762 | -2.1051 |
| SUBSOL | B1 | INF | Min | 1.4625 | -19.7491 | -7.2062 |
| SUBSOL | B1 | INF | Min | 1.95 | -16.1587 | -14.5296 |
| SUBSOL | B2 | INF | Max | 0.2 | 51.302 | 45.9945 |
| SUBSOL | B2 | INF | Max | 0.6167 | 54.2505 | 24.0535 |
| SUBSOL | B2 | INF | Max | 1.0333 | 58.6137 | 1.5666 |
| SUBSOL | B2 | INF | Max | 1.45 | 64.3917 | -5.7279 |
| SUBSOL | B2 | INF | Min | 0.2 | -14.2843 | -16.7285 |
| SUBSOL | B2 | INF | Min | 0.6167 | -11.3358 | -11.3419 |
| SUBSOL | B2 | INF | Min | 1.0333 | -6.9726 | -8.4558 |
| SUBSOL | B2 | INF | Min | 1.45 | -1.1947 | -24.9877 |

5.2 Eforturi în plăci

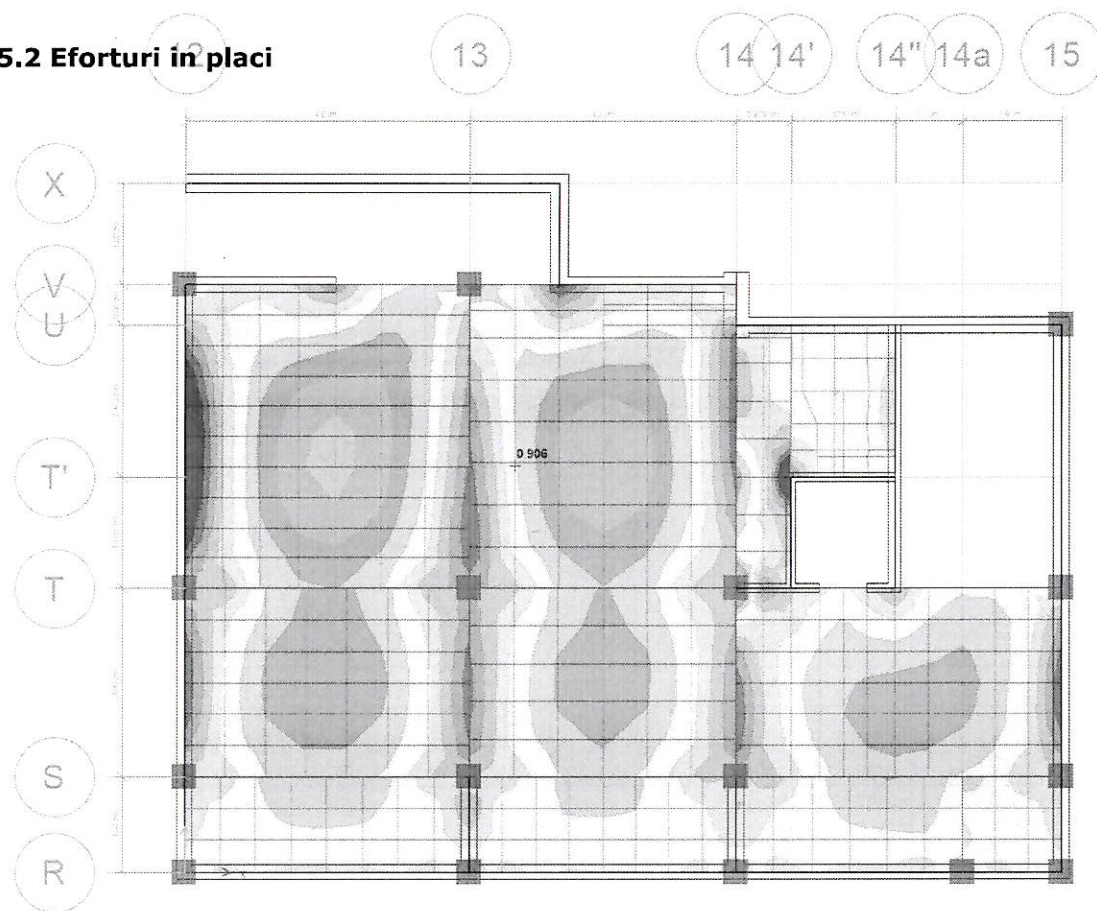

DIAGrame MOMENT ÎNCOVOIETOR M11 DIN INFASURATOARE ÎN PLANȘEU PESTE SUBSOL

Plan View - SUBSOL - Z = 3.25 (m) Resultant M22 Diagram (kN-m/m)

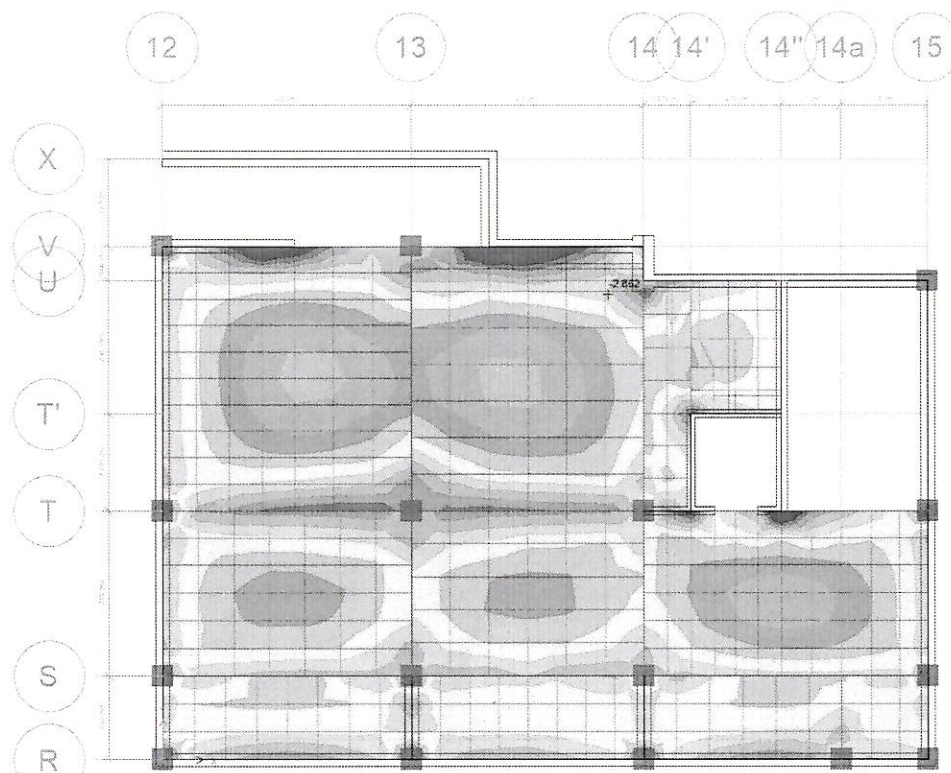

DIAGrame MOMENT ÎNCOVOIETOR M22 DIN INFASURATOARE ÎN PLANȘEU PESTE SUBSOL

-15.0 -12.7 -10.4 -8.1 -5.8 -3.5 -1.2 1.2 3.5 5.8 8.1 10.4

NOTE DE CALCUL - REALIZARE BLOC ALIMENTAR S+P+E IN CAZARMA 659 CRAIOVA

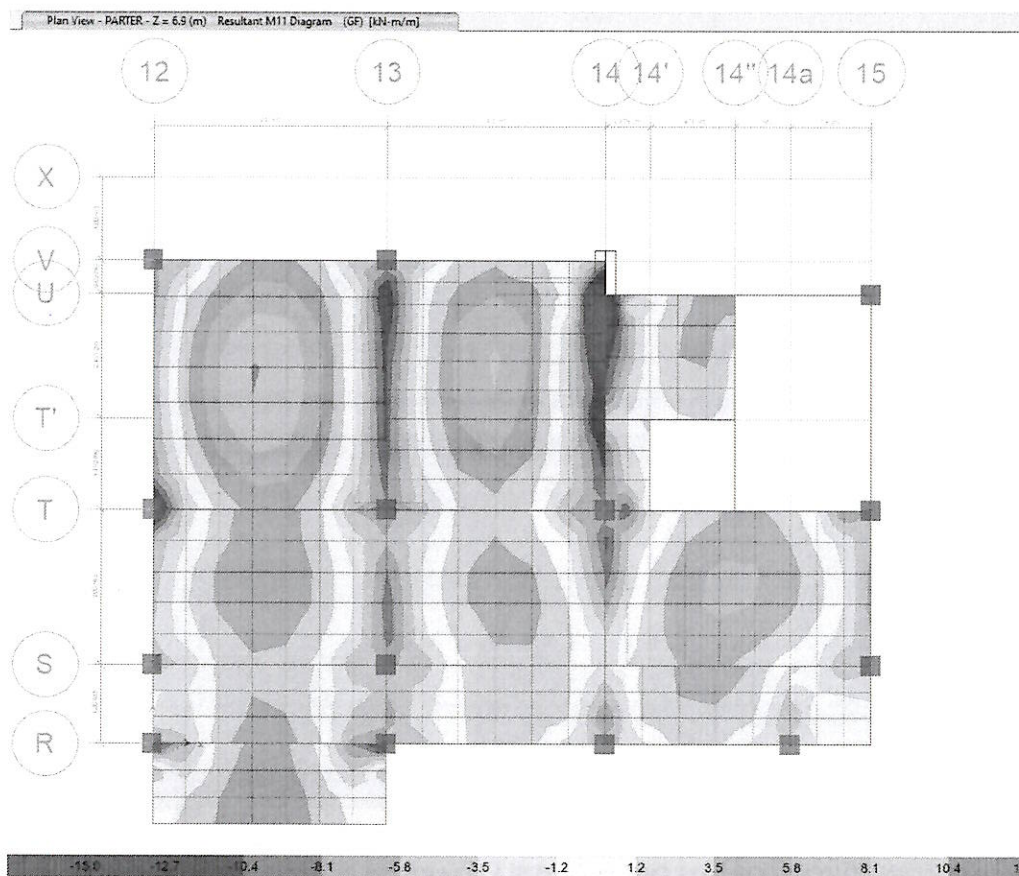

DIAGrame MOMENT INCOVOIETOR M11 DIN INFASURATOARE IN PLANSEU PESTE PARTER

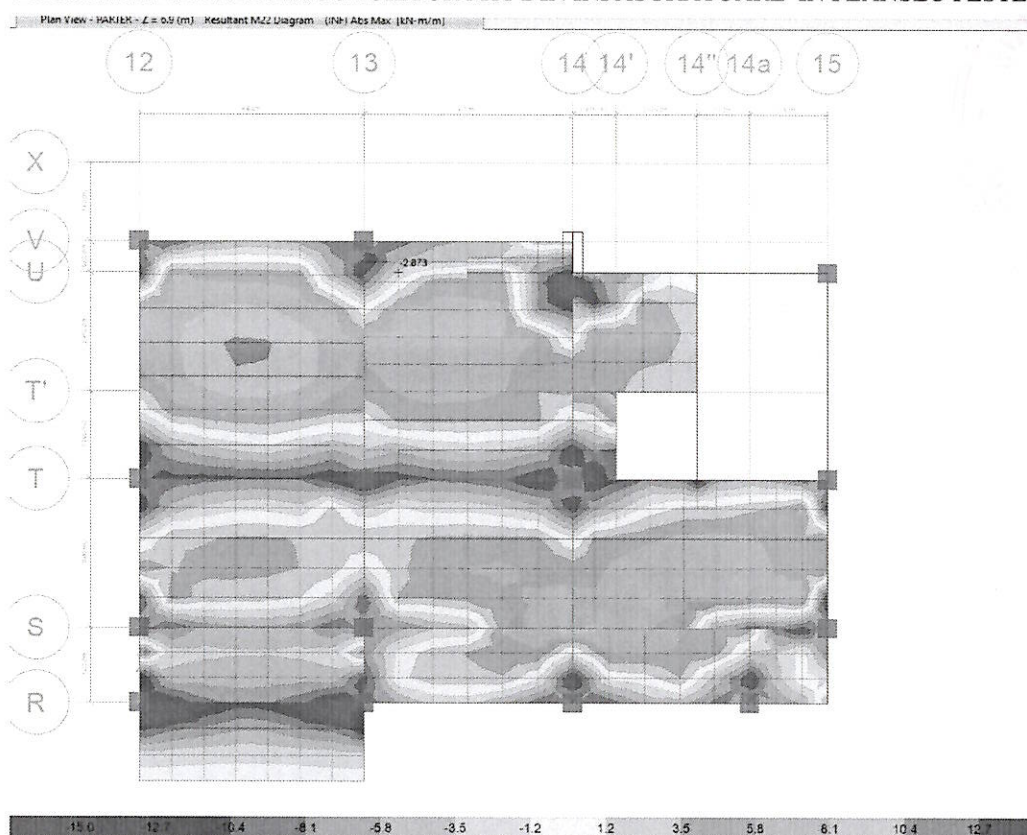

DIAGrame MOMENT INCOVOIETOR M22 DIN INFASURATOARE IN PLANSEU PESTE PARTER

BREVIAR DE CALCUL - REPARATII CAPITALE, CONSOLIDARE, RESTAURARE, EXTINDERE ȘI REFACERE
ÎMPREJMUIRE LA SEDIUL JUDECĂTORIEI HUȘI

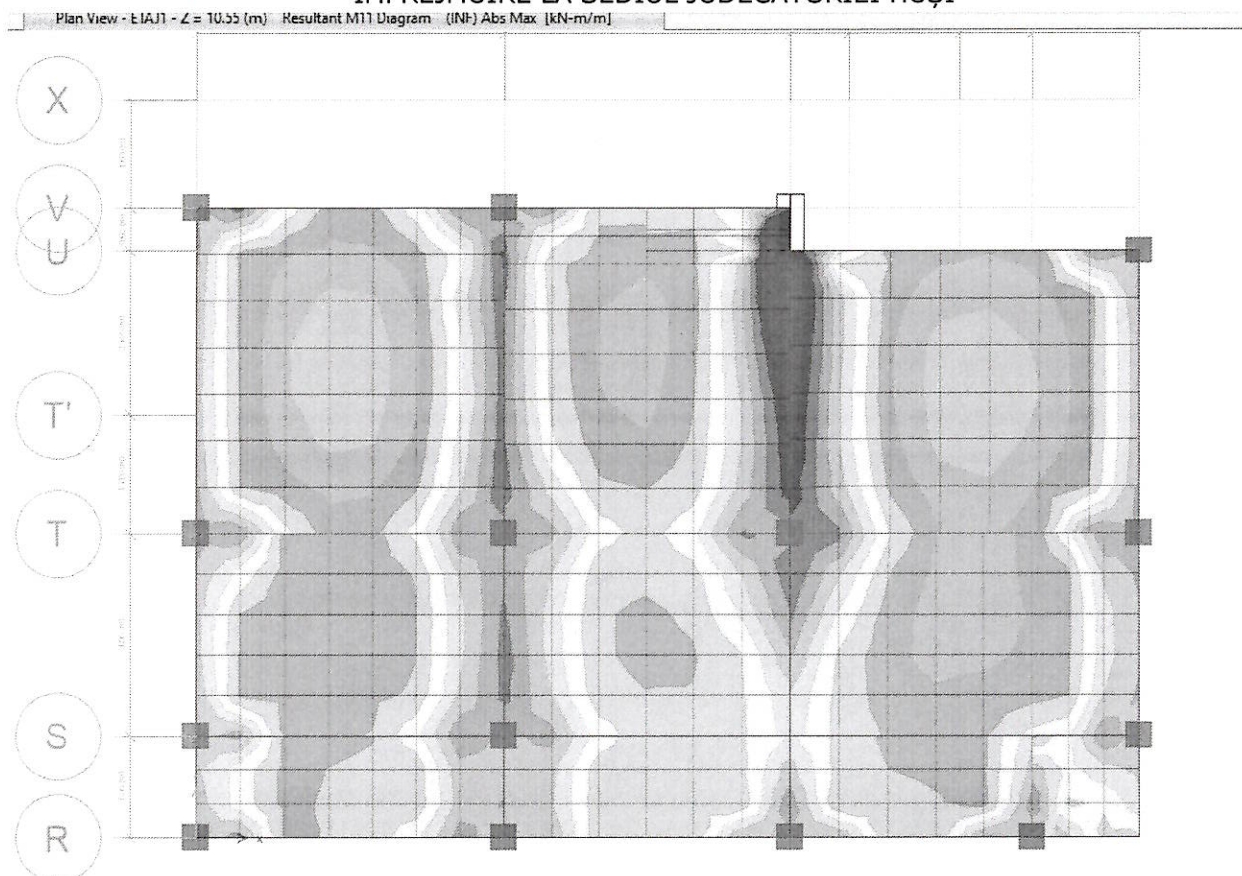

DIAGrame MOMENT INCOVOIETOR M11 DIN INFASURATOARE IN PLANSEU PESTE ETAJ 1

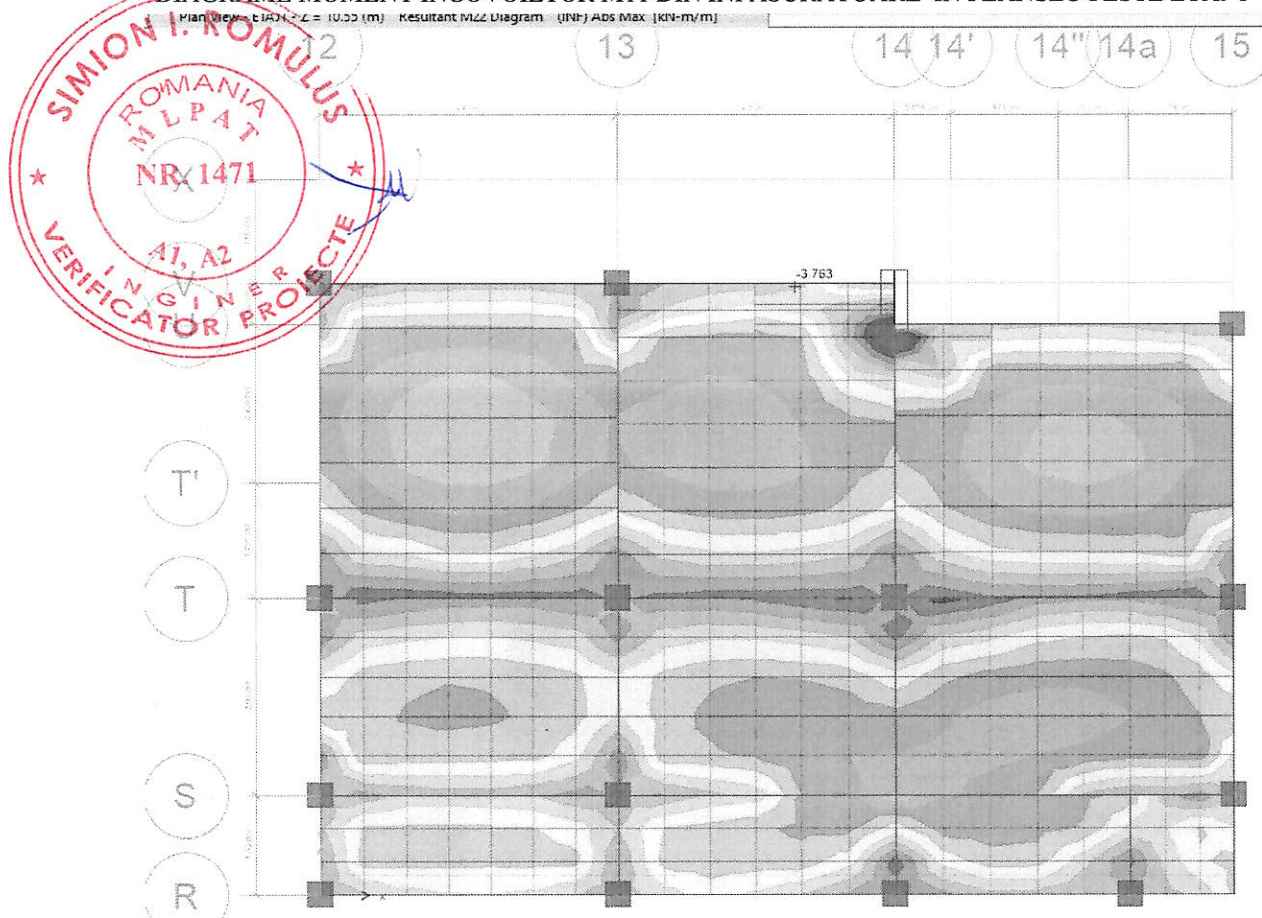

DIAGrame MOMENT INCOVOIETOR M22 DIN INFASURATOARE IN PLANSEU PESTE ETAJ 1

